

Pumper, PUC

Body
Pumper, PUC, Aluminum
Chassis
Enforcer Chassis, PUC

CHASSIS

AXLE, FRONT, CUSTOM
18,000 Lb Dana Axle
AXLE, REAR
27,000 Lb Dana Axle

ENGINE

400 HP Cummins L9 Engine

TRANSMISSION

Allison 5th Gen, 3000 EVS P

BUMPER

26" Extended Painted Steel

CAB

7010 Enforcer Cab, PUC

BODY

WATER TANK

1000 Gallon Poly Water Tank

COMPT, PUMPER, REAR

33.50" FF RollUp Rear Compt w/Tailboard, PUC

COMPT, PUMPER, LEFT SIDE

177" RollUp Full Height & Depth Front & Rear, PUC

COMPT, PUMPER, RIGHT SIDE

177" RollUp Full Height & Depth Front & Rear, PUC

FIRE SUPPRESSION

PUMPHOUSE

Control Zone, PUC

PUMP

1500 GPM Pierce PUC

CROSSLAYS, 1.50"

(1) 1.50", Poly Tray, 200'

CROSSLAYS, 2.50"

2.50" CrossLays Not Required

GENERATOR

Generator Not Required

Foam System

Husky 3 Single Agent Foam System

Foam Cell

20 Gallon Foam Cell, Not Reduced Water, PUC

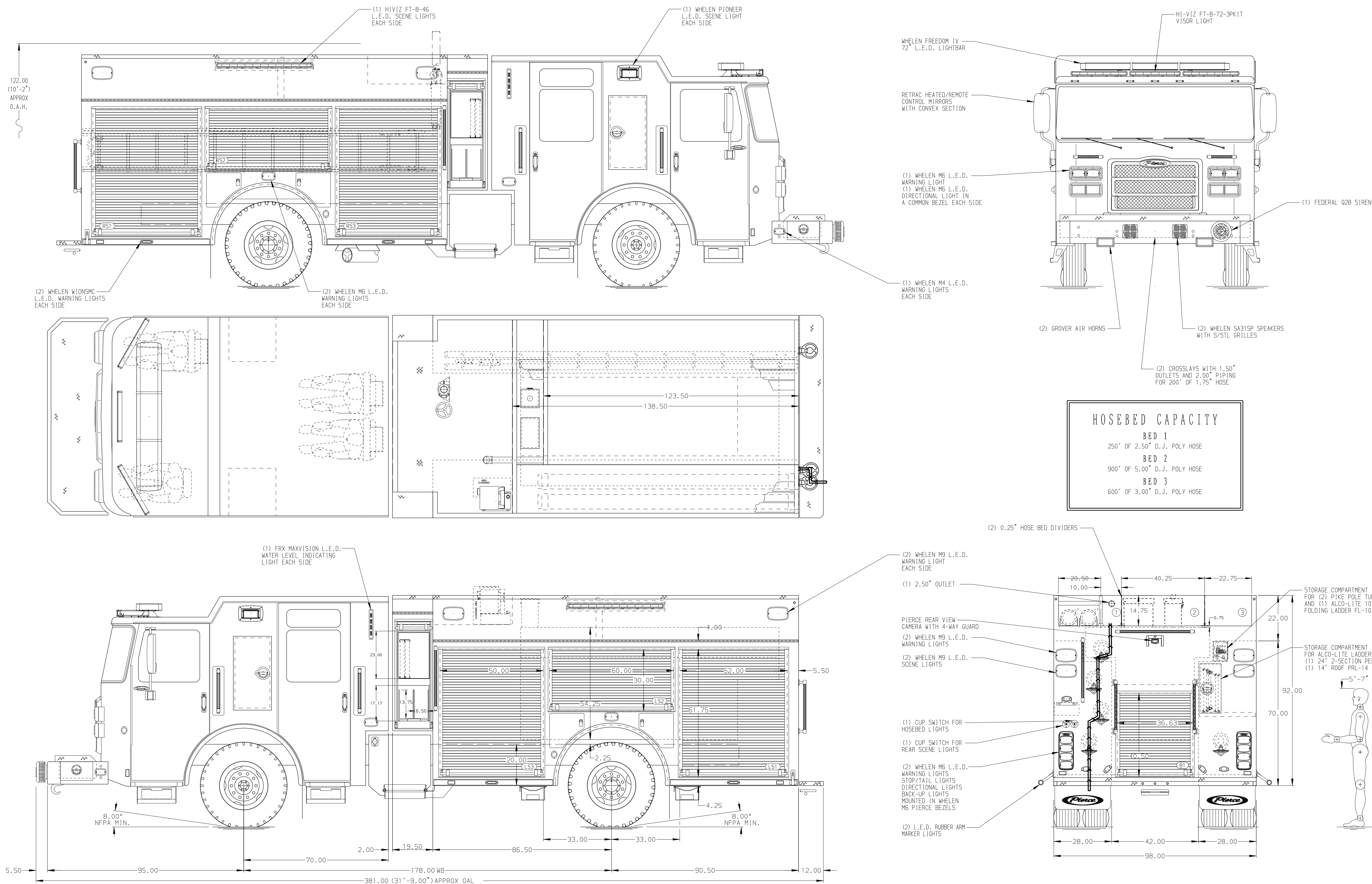

HOSEBED CAPACITY	
BED 1	250' OF 2.50" D.J. POLY HOSE
BED 2	900' OF 5.00" D.J. POLY HOSE
BED 3	600' OF 3.00" D.J. POLY HOSE

NOTE
DIMENSIONS SHOWN ARE APPROXIMATE AND ARE SUBJECT TO MINOR DEVIATIONS AS MAY OCCUR OR BE NECESSARY IN CONSTRUCTION. MINOR DETAILS NOT SHOWN.

1. SHORELINE RECEPTACLE WITH KUSSMALL SUPER AUTO-EJECT LOCATED ON DRIVER SIDE PUMP PANEL
2. AIR INLET WITH DISCONNECT COUPLING IN THE DRIVER SIDE STEPWELL
3. BATTERY CHARGER/INVERTER LOCATED BEHIND DRIVER'S SEAT
4. INVERTER/BATTERY CHARGER LOCATED PER SHOP ORDER

REV	DATE	BY	CH	ENFORCER
16SEP21	MMF	JJR		PIERCE
02AUG21	MMF	JJR		MODEL

Pierce MANUFACTURING INC.		JOB NO.	36304
		SCALE	1:24
		DATE	
TITLE	Pierce PUC Pumper Approval Drawing	DRAWN BY	MMF
FOR	Volusia County Fire Rescue	CHECKED BY	COL
DWG NO.	36304AD-SH1	SHEET SIZE	D
		SHEET NO.	1 OF 2