

**PUMPER BODY**

Long Aluminum 2nd Gen Pumper

**CHASSIS**

Enforcer Chassis

**CHASSIS AXLE, FRONT, CUSTOM**

19,500 lb TAK-4 Axle

**AXLE, REAR**

24,000 lb Meritor Axle

**ENGINE**

450 HP Cummins L9 Engine

**TRANSMISSION**

Allison 5th Gen, 3000 EVS P

**BUMPER**

19" Extended Painted Steel

**CAB**

7010 Enforcer Cab

**BODY WATER TANK**

750 Gallon Poly Water Tank

**COMPT, PUMPER, REAR**

34.75" FF RollUp Rear Compt

**COMPT, PUMPER, LEFT SIDE**

161" RollUp Full Height Front & Rear FDLR

**COMPT, PUMPER, RIGHT SIDE**

161" RollUp Full Height Front & Rear FDLR

**FIRE SUPPRESSION PUMPHOUSE**

48" Control Zone Side Mount

**PUMP**

1500 GPM Waterous CSU

**CROSSLAYS, 1.50"**

(2) 1.50" Standard Capacity

**CROSSLAYS, 2.50"**

2.50" Crosslay Not Required

**SPEEDLAYS**

Speedlays Not Required

**GENERATOR**

Generator Not Required

**Foam System**

Husky 12 Single Agent Foam System

**Foam Cell**

30 Gallon Foam Cell, Not Reduced Water

Side Roll and Frontal Impact Protection

**NOTE**  
DIMENSIONS SHOWN ARE APPROXIMATE AND ARE SUBJECT TO MINOR DEVIATIONS AS MAY OCCUR OR BE NECESSARY IN CONSTRUCTION. MINOR DETAILS NOT SHOWN.

- ONE 1.50" OUTLET WITH 2.00" PIPING AND SWIVEL LOCATED IN CENTER BUMPER TRAY
- SHORELINE RECEPTACLE WITH KUSSMALL SUPER AUTO-EJECT LOCATED ON DRIVER SIDE OF THE CAB
- AIR INLET WITH KUSSMALL AIR EJECT IN THE DRIVER SIDE STEPWELL
- BATTERY CHARGER LOCATED IN COMPARTMENT PER SHOP ORDER
- BATTERY CHARGE INDICATOR LOCATED ON THE DRIVER SIDE OF CAB
- NINE ADJUSTABLE SHELVES IN COMPARTMENTS PER SHOP ORDER

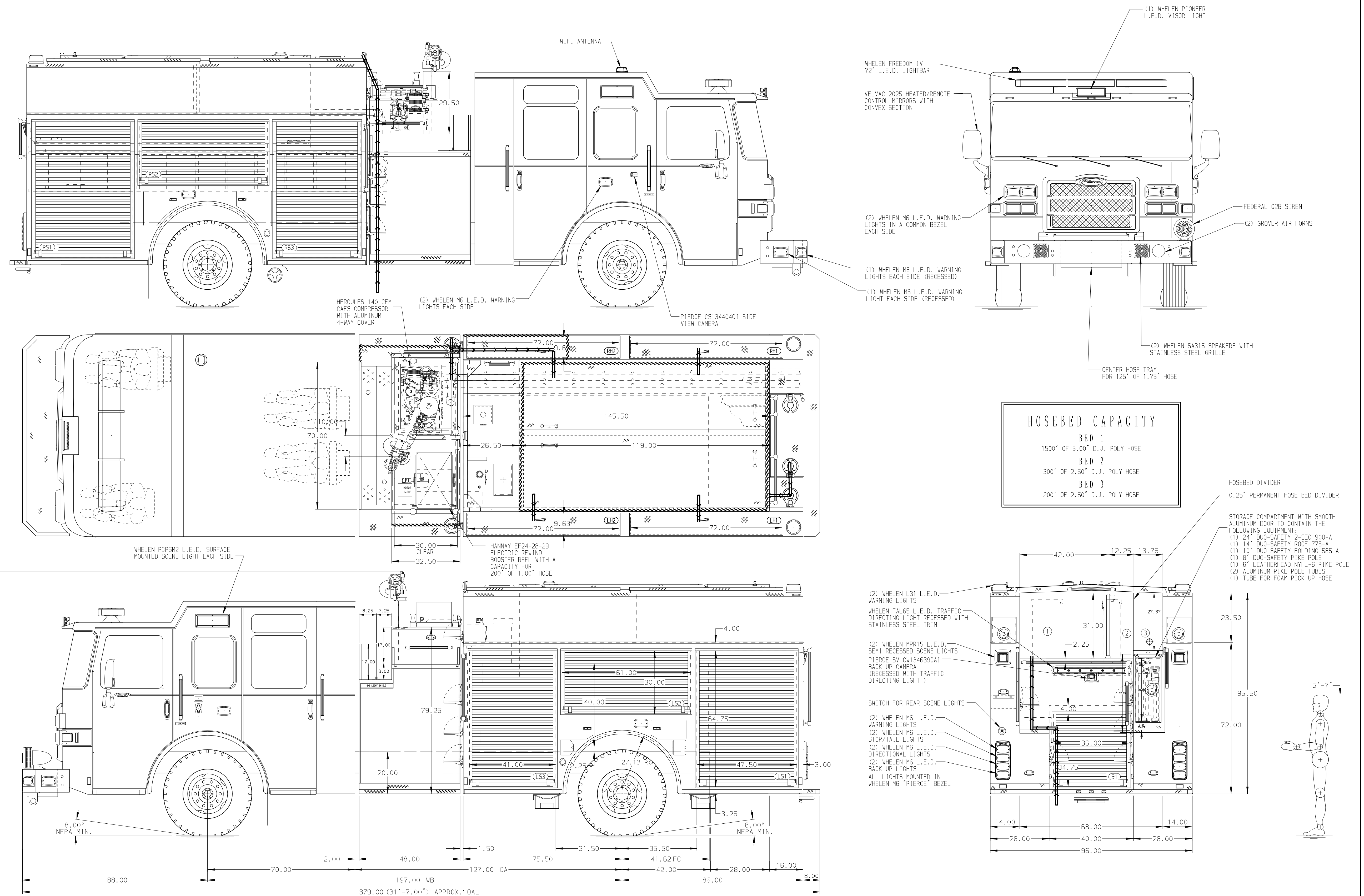

		JOB NO.	36702															
		SCALE	DATE															
<b>Pierce MANUFACTURING INC.</b>		TITLE	Pierce Pumper Approval Drawing															
		FOR	Fort Smith Fire Department															
<table border="1"> <tr> <th>REV</th> <th>DATE</th> <th>BY</th> <th>CH</th> <th>ENFORCER</th> </tr> <tr> <td>29SEP21</td> <td>MMF</td> <td>JGO</td> <td></td> <td></td> </tr> <tr> <td>26AUG21</td> <td>MMF</td> <td>JGO</td> <td></td> <td></td> </tr> </table>		REV	DATE	BY	CH	ENFORCER	29SEP21	MMF	JGO			26AUG21	MMF	JGO			DWG NO.	36702AD
		REV	DATE	BY	CH	ENFORCER												
29SEP21	MMF	JGO																
26AUG21	MMF	JGO																
<table border="1"> <tr> <th>CHASSIS DATA</th> <th>MAKE</th> <th>MODEL</th> </tr> <tr> <td>PIERCE</td> <td></td> <td></td> </tr> </table>		CHASSIS DATA	MAKE	MODEL	PIERCE			CHECKED BY	COL 14JUN21									
		CHASSIS DATA	MAKE	MODEL														
PIERCE																		
<table border="1"> <tr> <th>SHEET SIZE</th> <th>SHEET NO.</th> </tr> <tr> <td>D</td> <td>1 OF 1</td> </tr> </table>		SHEET SIZE	SHEET NO.	D	1 OF 1	DRAWN BY	MMF 14JUN21											
		SHEET SIZE	SHEET NO.															
D	1 OF 1																	