

PUMPER BODY

Long Aluminum 2nd Gen Pumper

CHASSIS

Velocity Chassis (Big Block)

CHASSIS AXLE, FRONT, CUSTOM

21,500 Lb Meritor Axle

AXLE, REAR

27,000 Lb Meritor Axle

ENGINE

500 HP Cummins X15 Engine

TRANSMISSION

Allison 5th Gen, 4000 EVS P

BUMPER

19" Extended Stainless Steel

CAB

7010 Velocity FR Cab

BODY

WATER TANK

750 Gallon Poly Water Tank

COMPT, PUMPER, REAR

37.75" FF RollUp Rear Compt

COMPT, PUMPER, LEFT SIDE

161" RollUp Full Height Front & Rear FDLR

COMPT, PUMPER, RIGHT SIDE

161" RollUp Full Height Front & Rear FDLR

FIRE SUPPRESSION PUMPHOUSE

52" Control Zone Side Mount

PUMP

1500 GPM Waterous CSU

CROSSLAYS, 1.50"

(2) 1.50" Standard Capacity

CROSSLAYS, 2.50"

(1) 2.50" Standard Capacity

SPEEDLAYS

Speedlays Not Required

GENERATOR

Generator Not Required

Foam System

Husky 12 Single Agent Foam System

Foam Cell

30 Gallon Foam Cell, Not Reduced Water

Side Roll and Frontal Impact Protection

NOTE
DIMENSIONS SHOWN ARE APPROXIMATE AND ARE SUBJECT TO MINOR DEVIATIONS AS MAY OCCUR OR BE NECESSARY IN CONSTRUCTION. MINOR DETAILS NOT SHOWN.

1. ONE 1.50" OUTLET WITH 2.00" PIPING AND SWIVEL LOCATED IN CENTER BUMPER TRAY
2. SHORELINE RECEPTACLE WITH KUSSMAUL SUPER AUTO-EJECT LOCATED ON DRIVER SIDE OF BUMPER
3. AIR INLET WITH DISCONNECT COUPLING IN THE DRIVER SIDE CAB CORNER
4. BATTERY CHARGER LOCATED IN COMPARTMENT PER SHOP ORDER
5. BATTERY CHARGE INDICATOR LOCATED NEAR DRIVER SEAT RISER WITH BRACKET
6. NINE ADJUSTABLE SHELVES IN COMPARTMENTS PER SHOP ORDER
7. ONE SWING-OUT TOOLBOARD IN COMPARTMENT PER SHOP ORDER

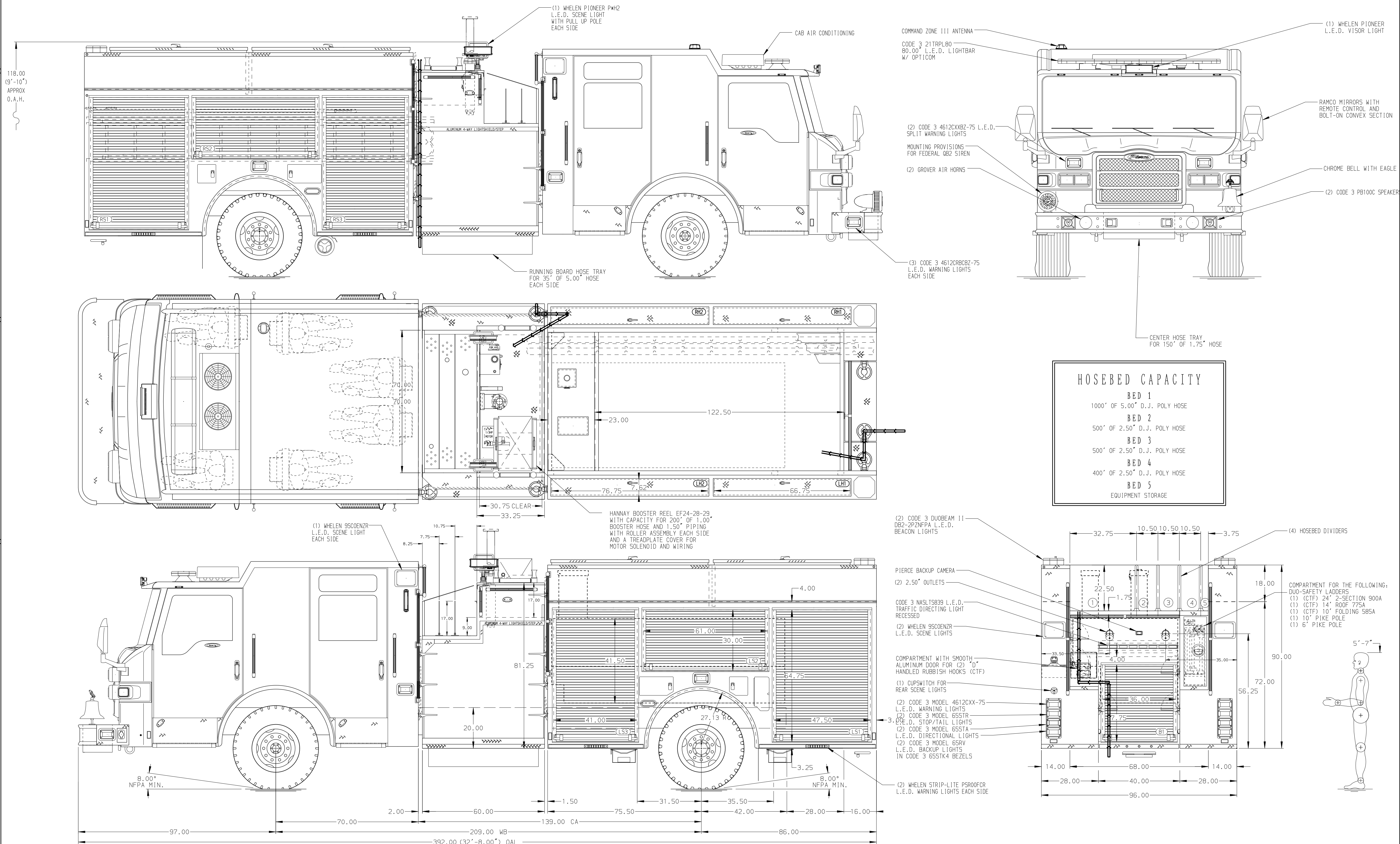

CUSTOMER APPROVAL

APPROVED BY: _____
DATE: _____



JOB NO.	37058 01-02
SCALE	1:24
DATE	DATE
DRAWN BY	MMF
CHECKED BY	COL
SHEET SIZE	SHEET NO.
D	1 OF 1

TITLE	Pierce Pumper Approval Drawing
MAKE	PIERCE
FOR	North Las Vegas Fire Department
DWG NO.	37058AD