

- WHELEN MPB\* MICRO L.E.D. TRACKING AND TIP LIGHT EACH SIDE
- (1) WHELEN PIONEER PP1 L.E.D. SCENE LIGHT EACH SIDE
- (1) WHELEN PIONEER P4H2\* L.E.D. VISOR LIGHT
- (2) WHELEN FREEDOM IV 21.50" L.E.D. LIGHTBARS
- RETRAC HEATED/REMOTE CONTROL MIRRORS WITH CONVEX SECTION
- (1) WHELEN SA315P SPEAKER WITH 5/STL GRILLE
- (2) WHELEN M5 L.E.D. WARNING LIGHTS EACH SIDE IN A COMMON BEZEL
- 22.00" PAINTED UNDERSLUNG BUMPER FOR 100' OF 1.75" HOSE AND HIGH RISE PACK WITH RAISED ALUMINUM TREADPLATE COVER WITH PARTITION
- (1) FEDERAL Q2B SIREN
- (2) GROVER 2040 RECT. STUTTERTONE AIR HORNS
- PIERCE SIDE VIEW CAMERA
- (1) WHELEN M9 L.E.D. WARNING LIGHT EACH SIDE

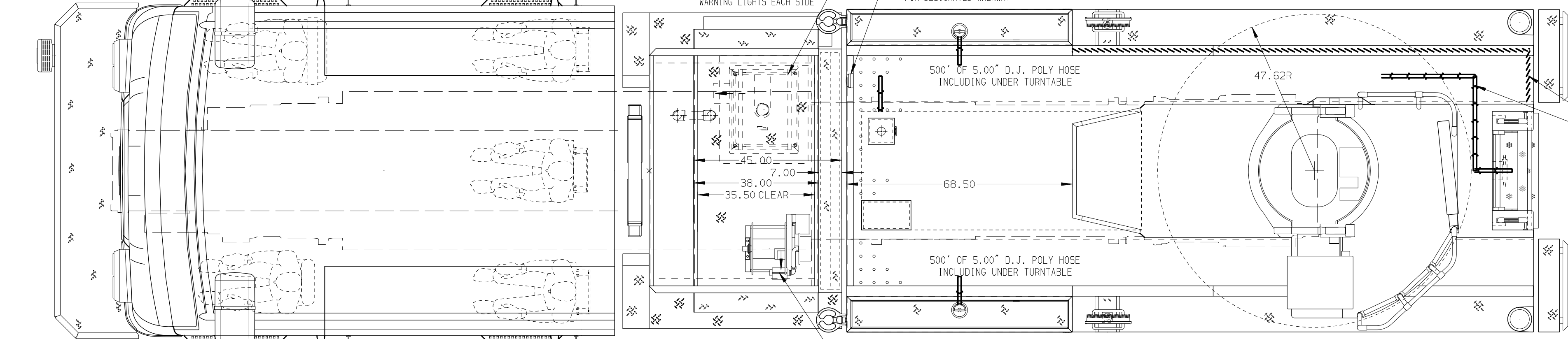

SURFACE DESIGNATION AND PATHWAY MARKINGS

<b>BODY</b>	<b>WATER TANK</b>
75' HAL Aluminum Body	530 Gallon Poly Water Tank
COMPT, LEFT SIDE FRONT	Foam System
Full Height RollUp Forward	External Foam System
COMPT, LEFT SIDE REAR	Foam Cell
Full Height RollUp Rearward	30 Gallon Foam Cell, Non-Reduced Water
COMPT, RIGHT SIDE FRONT	
Full Height RollUp Forward	
COMPT, RIGHT SIDE REAR	
Full Height RollUp Rearward	

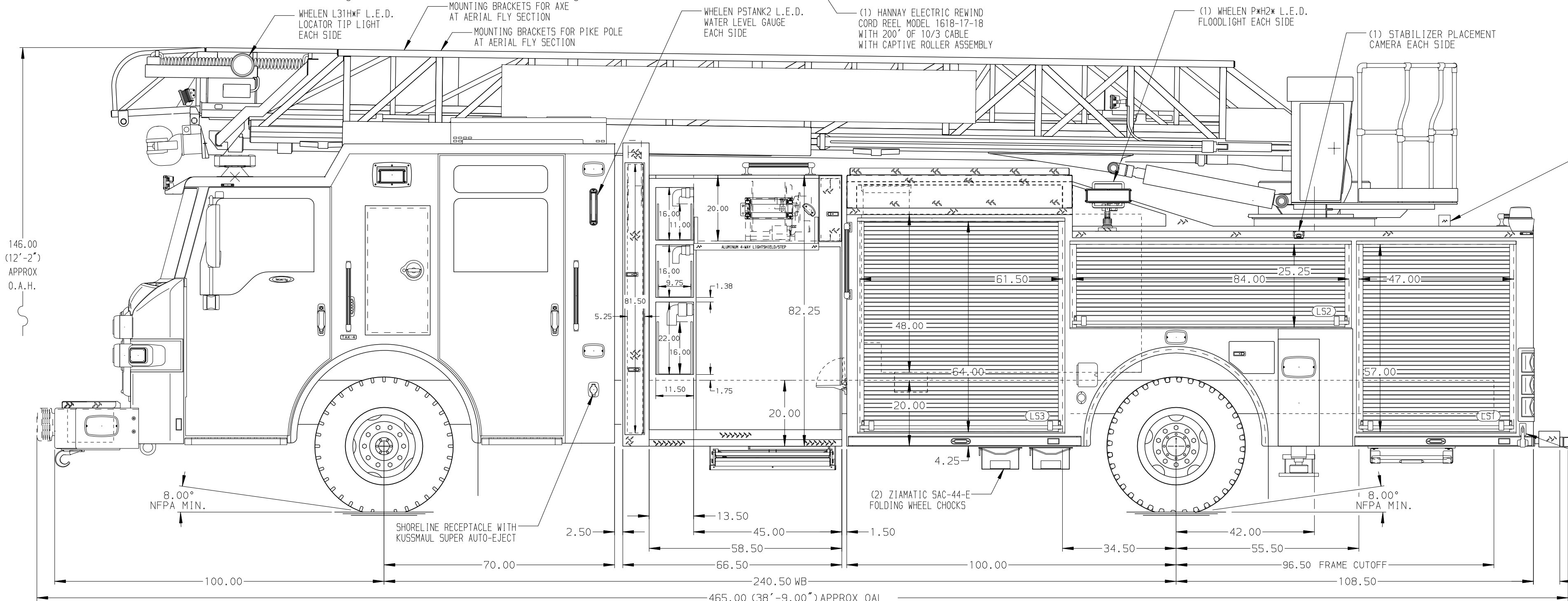

- (1) WHELEN TAL65 L.E.D. TRAFFIC DIRECTING LIGHT WITH TREADPLATE BOX
- (2) WHELEN BM7\*\*1P SUPER L.E.D. BEACON LIGHTS WITH WHELEN M7 L.E.D. WARNING LIGHT
- (2) WHELEN PIONEER PCP1 L.E.D. SCENE LIGHTS
- (2) WHELEN M9 L.E.D. WARNING LIGHTS
- LONG ITEM STORAGE ONE 24' 2-SEC 900 TWO 16" ROOF 875 REAR VIEW CAMERA
- (2) WRAP AROUND L.E.D. LIGHT SETS WITH STOP/TAIL, BACK UP AND DIRECTIONAL LIGHTS IN A COMMON BEZEL
- SWITCH FOR HOSE BED LIGHTS
- SWITCH FOR REAR SCENE LIGHTS
- (2) WHELEN M9 L.E.D. WARNING LIGHTS
- L.E.D. MARKER LIGHT WITH RUBBER ARM EACH SIDE
- LONG ITEM STORAGE ONE 35' 3-SEC 1225 ONE 10' FOLDING 585 FIVE PIKE POLES
- 80.25
- 72.25
- 65.25
- 5.00" AERIAL INLET
- ELECTRIC STABILIZER CONTROLS WITH SMOOTH ALUMINUM DOORS EACH SIDE

<b>CHASSIS</b> VELOCITY Chassis <b>ENGINE</b> 505 HP DD13 Engine	<b>CAB</b> 7010 Velocity Cab <b>BUMPER</b> 22" Extended Painted Steel	<b>AXLE, FRONT, CUSTOM</b> 22,800 Lb Dana Axle <b>AXLE, REAR</b> 33,500 Lb Meritor Axle	<b>TRANSMISSION</b> Allison 5th Gen, 4000 EV5 P	<b>PUMPHOUSE</b> 45" Control Zone Side Mount <b>PUMP</b> 2000 GPM Waterous CSU	<b>CROSSLAYS, 1.50"</b> 1.50" Crosslays Not Required <b>CROSSLAYS, 2.50"</b> 2.50" Crosslay Not Required	<b>SPEEDLAYS</b> (2) 1.50" W/Tray Std. Capacity (1) 2.50" W/Tray Std. Capacity	<b>SAFETY</b> Frontal Impact Protection <b>GENERATOR</b> Generator Mounting Only	<b>CUSTOMER APPROVAL</b> APPROVED BY: _____ DATE: _____		JOB NO. 37413																					
<b>NOTE</b> DIMENSIONS SHOWN ARE APPROXIMATE AND ARE SUBJECT TO MINOR DEVIATIONS AS MAY OCCUR OR BE NECESSARY IN CONSTRUCTION. MINOR DETAILS NOT SHOWN.	<ol style="list-style-type: none"> <li>1. AERIAL LIMITED RETRACTION NOT REQUIRED</li> <li>2. BATTERY CHARGER LOCATED IN COMPARTMENT PER ORDER</li> <li>3. DUAL L.E.D. LIGHT STRIPS LOCATED IN HOSE BED</li> <li>4. STAINLESS STEEL SOUFFPLATE ON BODY REAR CORNERS</li> <li>5. FIVE ADJUSTABLE FULL WIDTH/FULL DEPTH SHELVES IN COMPARTMENT PER ORDER</li> <li>6. ONE ADJUSTABLE SLIDE-OUT TRAY IN COMPARTMENT PER ORDER</li> <li>7. ONE ADJUSTABLE TILTING SLIDE-OUT TRAY IN COMPARTMENT PER ORDER</li> <li>8. THREE FLOOR MOUNTED SLIDE-OUT TRAYS IN COMPARTMENT PER ORDER</li> <li>9. ONE SWING-OUT ALUMINUM TOOL BOARD IN COMPARTMENT PER ORDER</li> <li>10. PAC TRAC ON THE WALL OF COMPARTMENT PER ORDER</li> </ol>	<ol style="list-style-type: none"> <li>11. CIRCUIT BREAKER PANEL IN COMPARTMENT PER ORDER</li> <li>12. TRIDENT FOLDING STEPS ON AERIAL DEVICE</li> <li>13. L.E.D. LIGHTING ON AERIAL LADDER SECTIONS</li> <li>14. 120V POWER TO AERIAL TIP</li> <li>15. FIRE RESEARCH 3-WAY INTERCOM SYSTEM BETWEEN AERIAL TIP, PUMP PANEL AND TURNTABLE</li> <li>16. AERIAL PEDESTAL RAISED 1.50"</li> <li>17. 1500 GPM HIGH FLOW WATERWAY</li> <li>18. REMOTE MONITOR CONTROLS AT PUMP PANEL</li> <li>19. AIR INLET WITH DISCONNECT COUPLING LOCATED ON DRIVER SIDE PUMP PANEL</li> <li>20. AIR OUTLET WITH SHUT OFF VALVE LOCATED ON PASSENGER SIDE PUMP PANEL</li> </ol>	<table border="1"> <tr> <td>CHASSIS DATA</td> <td>TITLE</td> <td>75 AERIAL LADDER &amp; BODY ASSEMBLY</td> </tr> <tr> <td>MAKE</td> <td>FOR</td> <td>SAN CARLOS PARK FIRE DISTRICT SAN CARLOS, FL</td> </tr> <tr> <td>PIERCE</td> <td>DWG NO.</td> <td>37413AD</td> </tr> <tr> <td>MODEL</td> <td>SHEET NO.</td> <td>D</td> </tr> <tr> <td>VELOCITY</td> <td>DATE</td> <td>1 OF 1</td> </tr> </table>	CHASSIS DATA	TITLE	75 AERIAL LADDER & BODY ASSEMBLY	MAKE	FOR		SAN CARLOS PARK FIRE DISTRICT SAN CARLOS, FL	PIERCE	DWG NO.	37413AD	MODEL	SHEET NO.	D	VELOCITY	DATE	1 OF 1	<table border="1"> <tr> <td>SCALE</td> <td>DATE</td> </tr> <tr> <td>1:24</td> <td>08DEC21</td> </tr> <tr> <td>CHECKED BY</td> <td>DATE</td> </tr> <tr> <td>NDA</td> <td>10DEC21</td> </tr> <tr> <td>SHEET SIZE</td> <td>SHEET NO.</td> </tr> <tr> <td>D</td> <td>1 OF 1</td> </tr> </table>	SCALE	DATE	1:24	08DEC21	CHECKED BY	DATE	NDA	10DEC21	SHEET SIZE	SHEET NO.	D
CHASSIS DATA	TITLE	75 AERIAL LADDER & BODY ASSEMBLY																													
MAKE	FOR	SAN CARLOS PARK FIRE DISTRICT SAN CARLOS, FL																													
PIERCE	DWG NO.	37413AD																													
MODEL	SHEET NO.	D																													
VELOCITY	DATE	1 OF 1																													
SCALE	DATE																														
1:24	08DEC21																														
CHECKED BY	DATE																														
NDA	10DEC21																														
SHEET SIZE	SHEET NO.																														
D	1 OF 1																														