

# PUMPER BODY

Medium Aluminum 2nd Gen Pumper

# CHASSIS

Impel Chassis

# CHASSIS AXLE, FRONT, CUSTOM

19,500 Lb TAK-4 Axle

# AXLE, REAR

27,000 Lb Dana Axle

# ENGINE

450 HP Cummins L9 Engine

# TRANSMISSION

Allison 5th Gen, 3000 EVS P

# BUMPER

19" Extended Stainless Steel

# CAB

7010 Impel FR Cab

# BODY

## WATER TANK

750 Gallon Poly Water Tank

## COMPT, PUMPER, REAR

37.75" FF RollUp Rear Compt

## COMPT, PUMPER, LEFT SIDE

152" RollUp Full Height Front & Rear FDLR

## COMPT, PUMPER, RIGHT SIDE

152" RollUp Full Height Front & Rear FDLR

# FIRE SUPPRESSION PUMPHOUSE

42" Control Zone Top Mount

## PUMP

2000 GPM Waterous CSU

## CROSSLAYS, 1.50"

1.50" Crosslays Not Required

## CROSSLAYS, 2.50"

2.50" Crosslay Not Required

## SPEEDLAYS

(2) 1.50" Std. Capacity

(1) 2.50" Std. Capacity

## GENERATOR

Generator Not Required

## Foam System

Husky 3 Single Agent Foam System

## Foam Cell

20 Gallon Foam Cell, Not Reduced Water

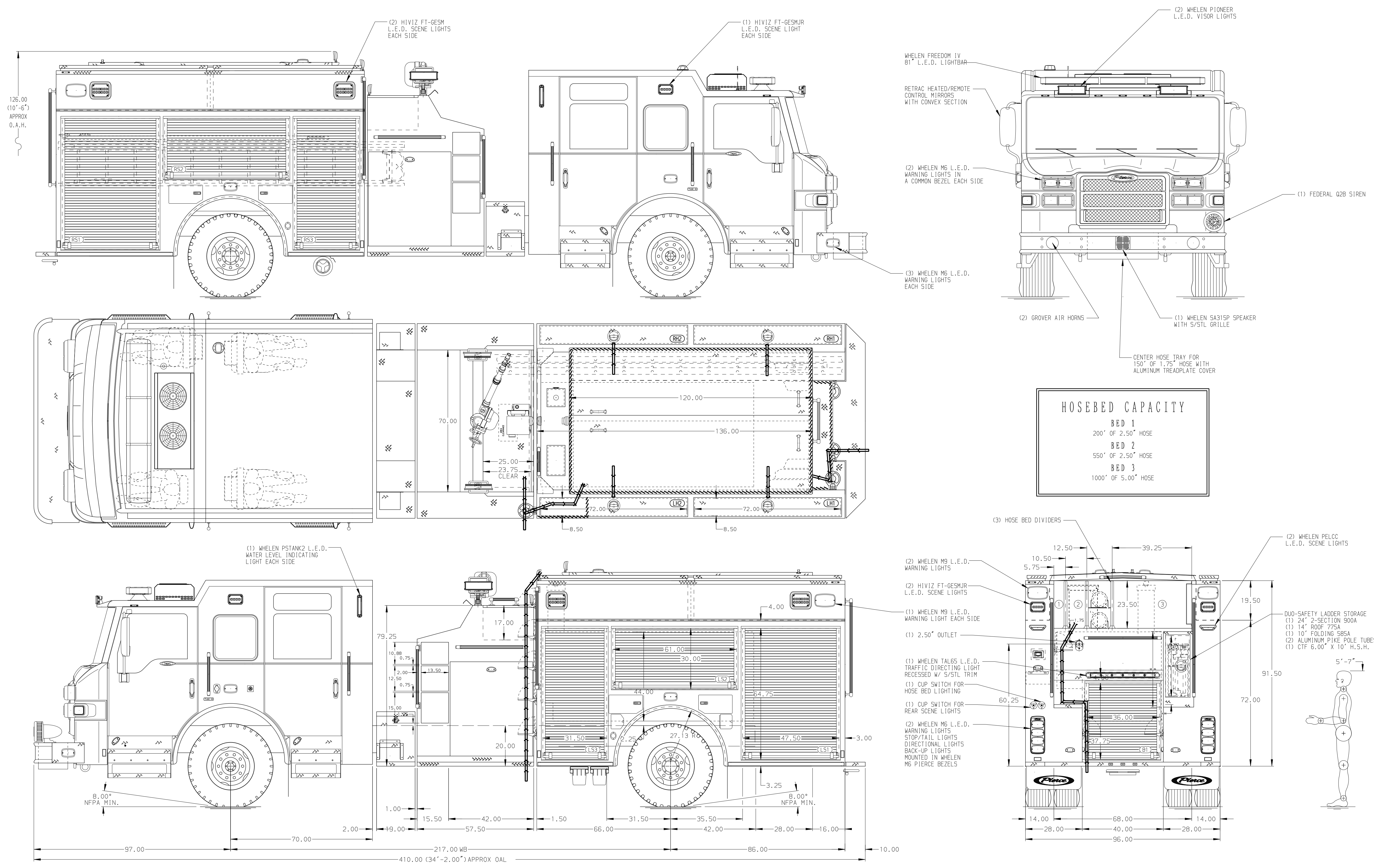

HOSEBED CAPACITY	
BED 1	200' OF 2.50" HOSE
BED 2	550' OF 2.50" HOSE
BED 3	1000' OF 5.00" HOSE

### CUSTOMER APPROVAL

APPROVED BY: \_\_\_\_\_  
DATE: \_\_\_\_\_



JOB NO. 37629  
SCALE 1:24  
DATE

REV	DATE	BY	CH
-	-	-	-

TITLE	FOR	DWG NO.
Pierce Pumper Approval Drawing	Bellevue Fire Department	37629AD

CHECKED BY	SHEET SIZE	SHEET NO.
MMF	D	1 OF 1

**NOTE**  
DIMENSIONS SHOWN ARE APPROXIMATE AND ARE SUBJECT TO MINOR DEVIATIONS AS MAY OCCUR OR BE NECESSARY IN CONSTRUCTION. MINOR DETAILS NOT SHOWN.

- ONE 1.50" OUTLET WITH 2.00" PIPING AND SWIVEL LOCATED IN CENTER BUMPER TRAY
- SHORELINE RECEPTACLE WITH KUSSMAUL SUPER AUTO-EJECT LOCATED ON DRIVER SIDE OF THE CAB
- AIR INLET WITH KUSSMAUL AUTO-EJECT LOCATED ON DRIVER SIDE OF THE CAB
- BATTERY CHARGER LOCATED BEHIND DRIVER'S SEAT
- BATTERY CHARGE INDICATOR LOCATED NEAR DRIVER SEAT RISER WITH BRACKET
- SIX ADJUSTABLE SHELVES LOCATED PER ORDER
- ONE FLOOR MOUNTED SLIDE-OUT TRAY LOCATED PER ORDER
- THREE SLIDE-OUT TOOLBOARDS LOCATED PER SHOP ORDER