

PUMPER BODY
Long Aluminum 2nd Gen Pumper

CHASSIS
Enforcer Chassis

CHASSIS AXLE, FRONT, CUSTOM
20,000 Lb Dana Axle

AXLE, REAR
27,000 Lb Dana Axle

ENGINE
450 HP Cummins L9 Engine

TRANSMISSION
Allison 5th Gen, 3000 EVS P

BUMPER
19" Extended Stainless Steel

CAB
7010 Enforcer Cab

BODY WATER TANK
1000 Gallon New York Style Water Tank

COMPT, PUMPER, REAR
30.75" FF RollUp Flush Rear Compt

COMPT, PUMPER, LEFT SIDE
161" RollUp Full Height Front & Rear FDLR

COMPT, PUMPER, RIGHT SIDE
161" RollUp Full Height Front & Rear FDLR

FIRE SUPPRESSION PUMPHOUSE
48" Control Zone Top Mount

PUMP
1500 GPM Waterous CSU

CROSSLAYS, 1.50"
1.50" Crosslays Not Required

CROSSLAYS, 2.50"
2.50" Crosslay Not Required

SPEEDLAYS
(2) 1.50" W/Tray Std. Capacity

GENERATOR
Generator Not Required

Foam System
Husky 3 Single Agent Foam System

Foam Cell
30 Gallon Foam Cell, Not Reduced Water

NOTE
DIMENSIONS SHOWN ARE APPROXIMATE AND ARE SUBJECT TO MINOR DEVIATIONS AS MAY OCCUR OR BE NECESSARY IN CONSTRUCTION. MINOR DETAILS NOT SHOWN.

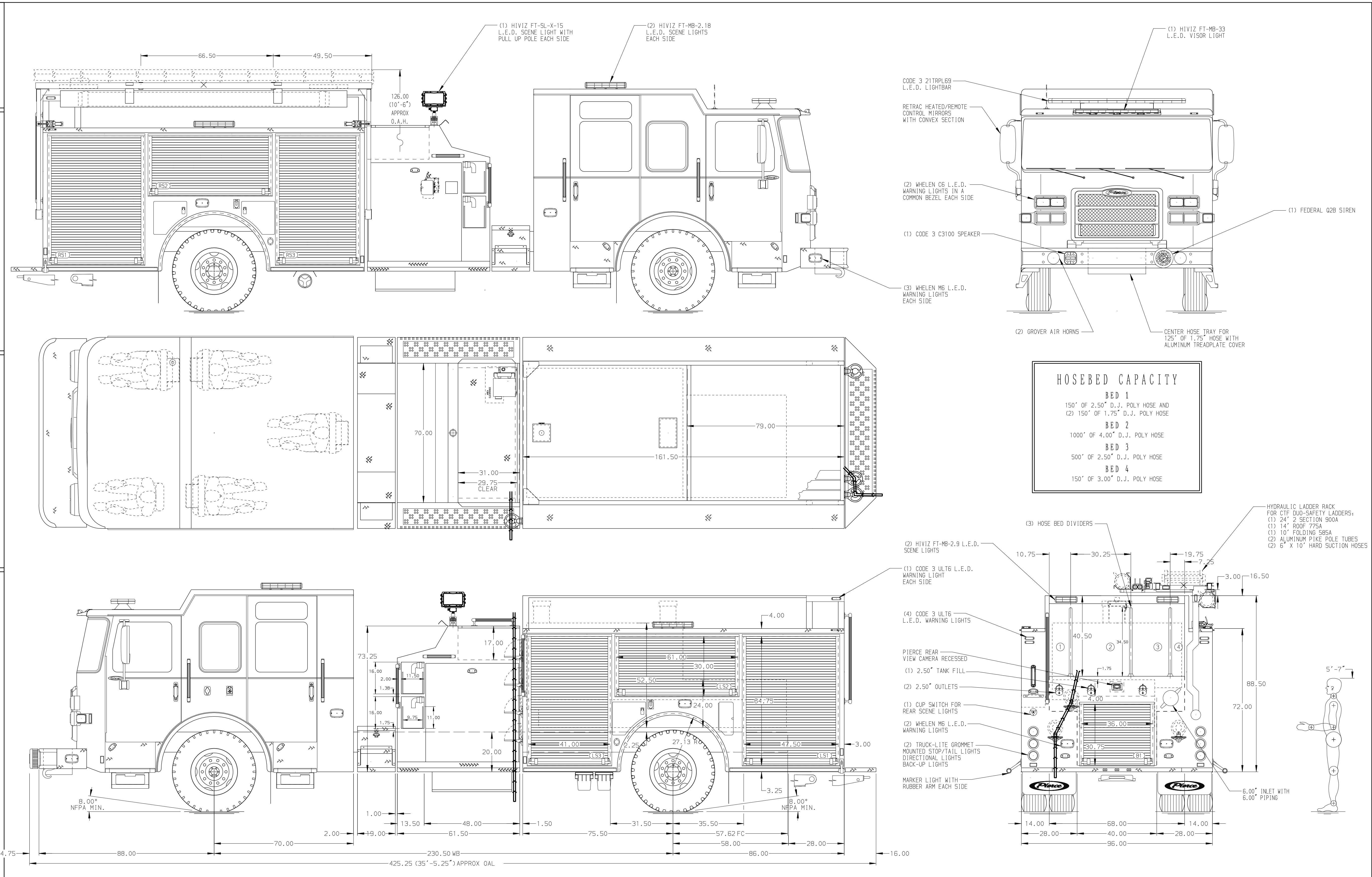

CUSTOMER APPROVAL				Pierce MANUFACTURING INC.		JOB NO.	37941
APPROVED BY: _____						SCALE	DATE
DATE: _____						1:24	
CHASSIS DATA		TITLE	Pierce Pumper Approval Drawing				
MAKE		FOR	Lake Tomahawk VFD				
PIERCE		DWG NO.	37941AD				
MODEL		SHEET SIZE	D				
REV	DATE	BY	CH	ENFORCER	SHEET NO.	1 OF 1	

- ONE 1.50 OUTLET WITH 2.00 PIPING AND SMIVEL LOCATED IN CENTER BUMPER TRAY
- SHORELINE RECEPTACLE WITH KUSSMAUL SUPER AUTO-EJECT LOCATED DRIVER SIDE ABOVE FRONT TIRE
- AUTOMATIC TIRE CHAINS
- KUSSMAUL AIR INLET WITH DISCONNECT COUPLING AND COVER ON DRIVER SIDE ABOVE FRONT TIRE
- TWELVE ADJUSTABLE SHELVES LOCATED PER SHOP ORDER
- ONE ADJUSTABLE SLIDE-OUT TRAY LOCATED PER SHOP ORDER
- TWO FLOOR MOUNTED SLIDE-OUT TRAYS LOCATED PER SHOP ORDER
- BATTERY CHARGER/INVERTER LOCATED BEHIND DRIVER'S SEAT
- TWO 120V 5-PLACE RECEPTACLES LOCATED PER SHOP ORDER
- THREE 120V 6-PLACE RECEPTACLES LOCATED PER SHOP ORDER