

- HOSEBED CAPACITIES
- ① 250' OF 2.50" D.J. POLY HOSE (PRECONNECTED)
 - ② 800' OF 5.00" D.J. POLY HOSE
 - ③ 500' OF 2.50" D.J. POLY HOSE (PRECONNECTED)

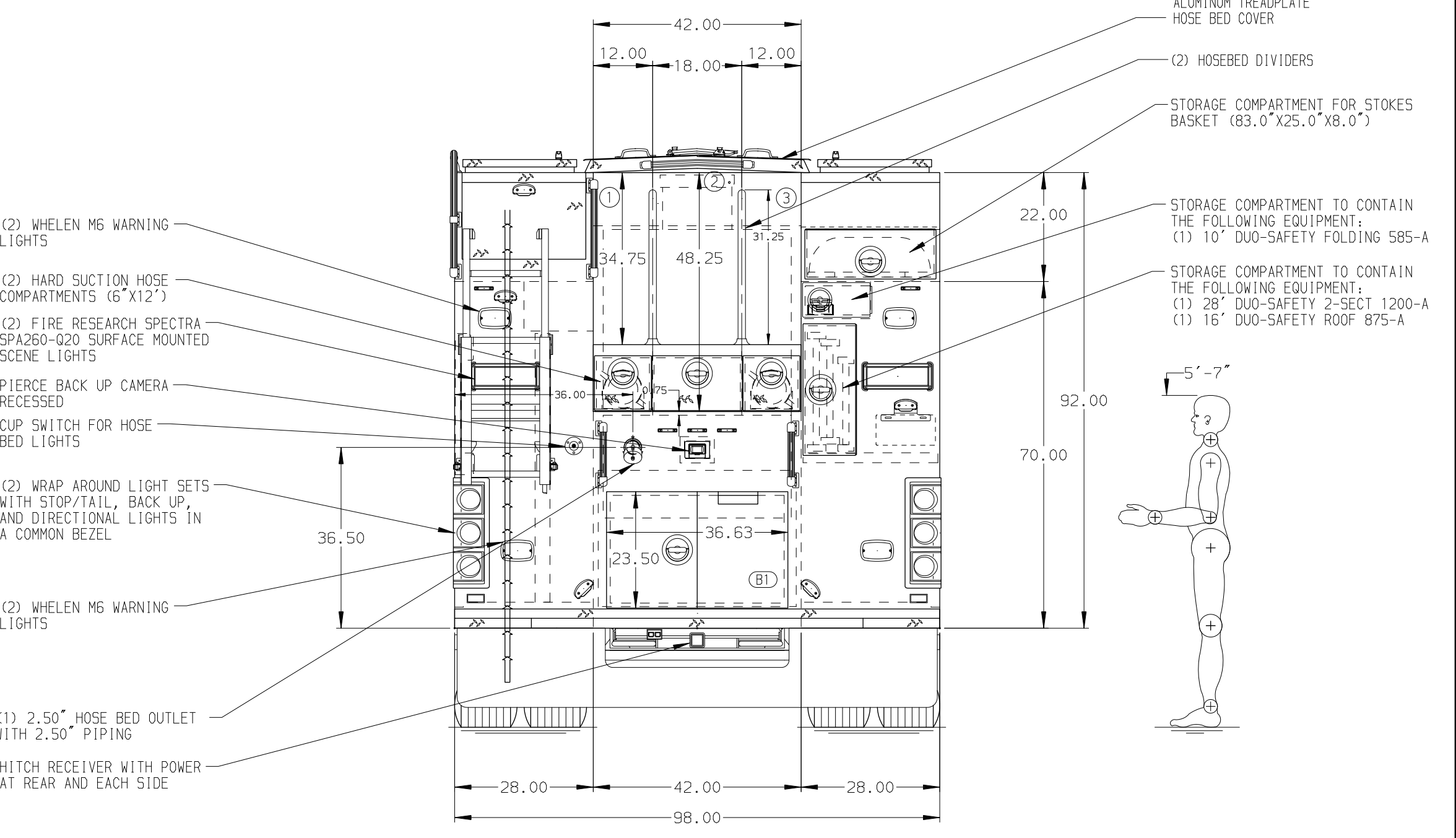
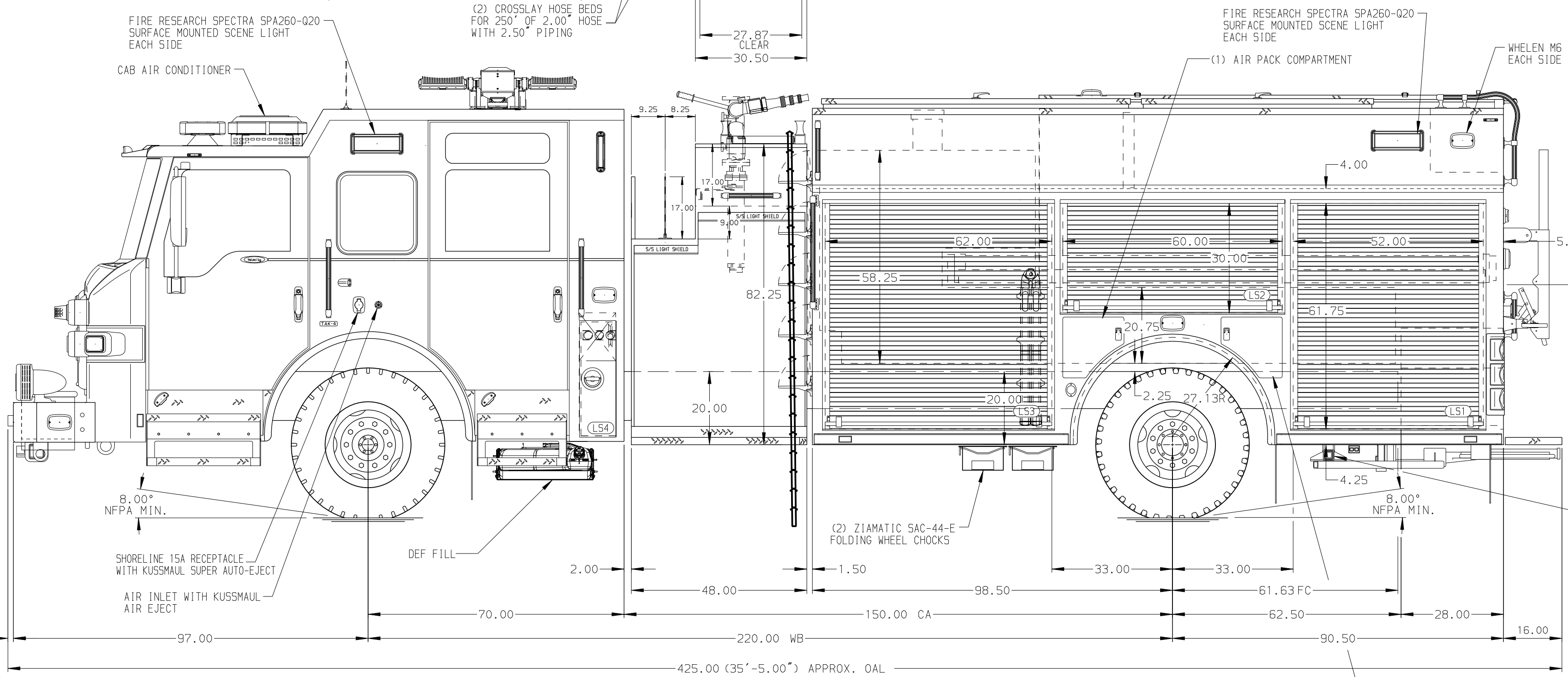

ALUMINUM BODY MAXIMUM O.A.L. 425.00" SIDE ROLL AND FRONTAL IMPACT PROTECTION

NOTE
 DIMENSIONS SHOWN ARE APPROXIMATE AND ARE SUBJECT TO MINOR DEVIATIONS AS MAY OCCUR OR BE NECESSARY IN CONSTRUCTION. MINOR DETAILS NOT SHOWN.

- 1. DEF TANK MOUNTED UNDER CAB ON THE DRIVER'S SIDE
- 2. BATTERY CHARGER LOCATED BEHIND DRIVER'S SEAT
- 3. LIGHT TOWER CONTROLLER LOCATED PER ORDER
- 4. AMCOR AY-LB-12HW0 WALKING SURFACE LIGHTS LOCATED PER ORDER
- 5. DUAL L.E.D. LIGHT STRIPS LOCATED IN HOSE BED

REV	DATE	BY	CH	VELOCITY
1	10JAN24	BST	CSH	CHASSIS DATA
2	06OCT23	BTH	PHA	MAKE
3	03OCT23	BTH	CSH	PIERCE
4	02OCT23	BTH	CSH	MODEL
5	27JUL23	LST	CSH	PIERCE

		JOB NO.	37955
		SCALE	1:24
TITLE 1500-D-750P, 189" HDRP 3G BODY, DELUGE, LIGHT TOWER LADDERS THRU BODY, 48" SIDE CONTROL	FOR BERLIN FIRE DEPARTMENT BERLIN, CONNECTICUT	DRAWN BY	BTH
		CHECKED BY	PHA
DWG NO.	37955AD-SH1	SHEET SIZE	D
		SHEET NO.	1 OF 2