

HOSEBED CAPACITIES

① 1000' OF 5.00" D.J. POLY HOSE

② 500' OF 2.50" D.J. POLY HOSE

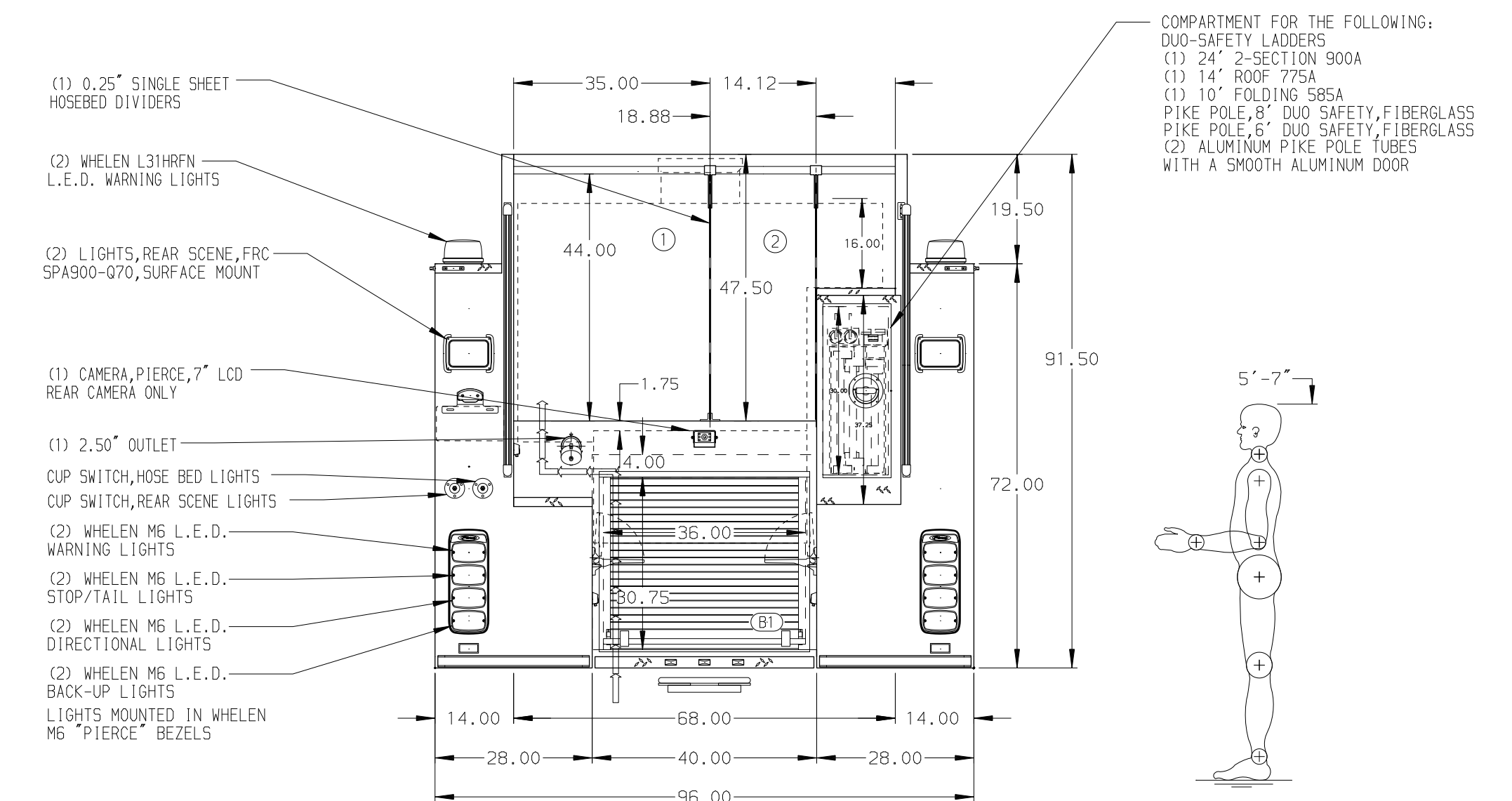
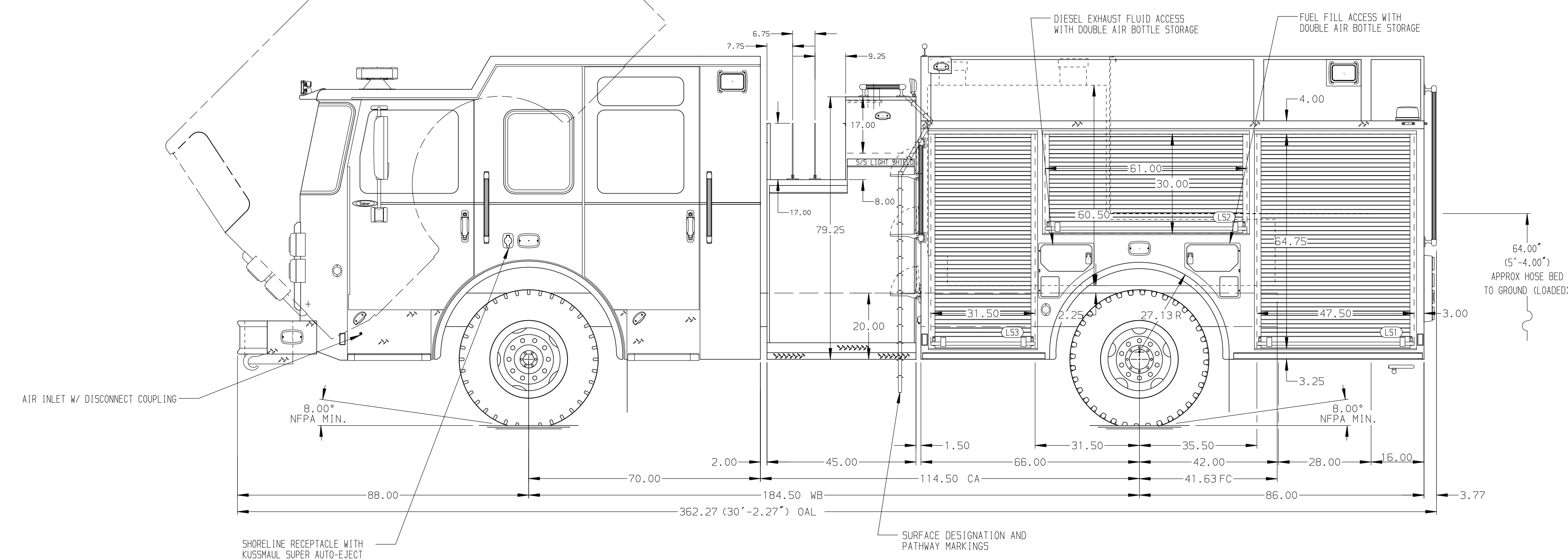

ALUMINUM BODY

NOTE
 DIMENSIONS SHOWN ARE APPROXIMATE AND ARE SUBJECT TO MINOR DEVIATIONS AS MAY OCCUR OR BE NECESSARY IN CONSTRUCTION. MINOR DETAILS NOT SHOWN.

		JOB NO.	37956						
		SCALE	DATE						
CHASSIS DATA MAKE PIERCE MODEL	TITLE	1500-D-750P, 725G WATER 25G FOAM, 152" NEW YORK STYLE PUMPER, (2) CROSSLAYS, 45" PUMPHOUSE, DELUGE	DRAWN BY	JLA	17MAR22				
	FOR	PIERCE FIELD UNIT BRADENTON, FLORIDA	CHECKED BY	NAS	17MAR22				
REV	DATE	BY	CH	SABER FR	DWG NO.	37956AD	SHEET SIZE	SHEET NO.	1 OF 1