

<b>BODY</b> 107' ASL Aluminum Body PUC <b>COMPT, LEFT SIDE FRONT</b> Full Height RollUp Forward <b>COMPT, LEFT SIDE REAR</b> Full Height RollUp Rearward <b>COMPT, RIGHT SIDE FRONT</b> Full Height RollUp Forward <b>COMPT, RIGHT SIDE REAR</b> Full Height RollUp Rearward-Large Rear	<b>WATER TANK</b> 500 Gallon Poly Water Tank <b>Foam System</b> Foam System Not Required <b>Foam Cell</b> Foam Cell Not Required
--	---

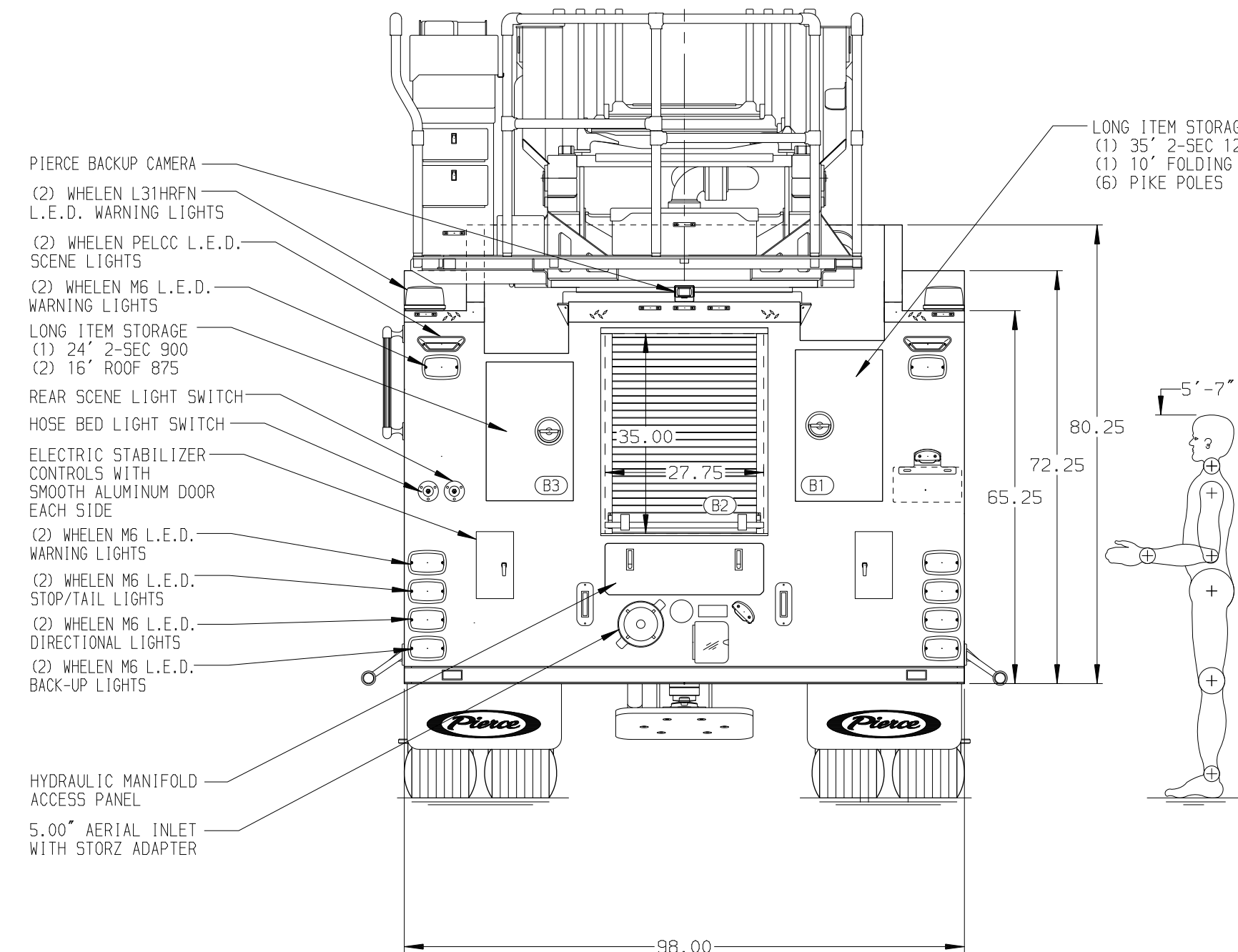

<b>CHASSIS</b> Enforcer Chassis, PUC <b>ENGINE</b> 450 HP Cummins L9 Engine	<b>CAB</b> 7000 Enforcer Cab, PUC <b>BUMPER</b> 22' Ext Painted Steel-Underslung	<b>AXLE, FRONT, CUSTOM</b> 22,800 Lb T4K-4 Axle <b>AXLE, REAR</b> 33,500 Lb Meritor Axle	<b>TRANSMISSION</b> Allison 6th Gen, 3000 EVS P	<b>PUMPHOUSE</b> Control Zone, PAL/PAP PUC <b>PUMP</b> 1500 GPM Pierce PUC	<b>CROSSLAYS, 1.50"</b> (2) 1.50", Poly Trays, 200' <b>DEADLAYS, 2.50"</b> (2) 2.50", Poly Trays, 200'	<b>SPEEDLAYS</b> Speedlays Not Required <b>GENERATOR</b> Generator Not Required
--	---	---	--	---	---	--

**CUSTOMER APPROVAL**  
APPROVED BY: \_\_\_\_\_  
DATE: \_\_\_\_\_

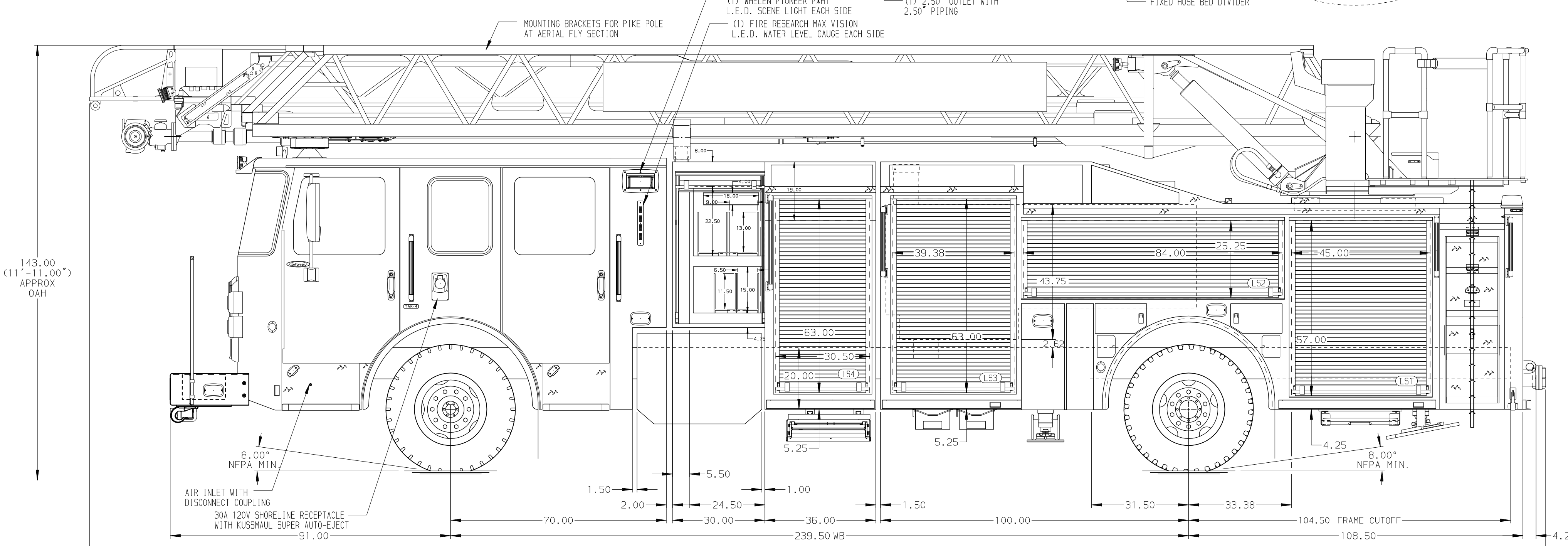

JOB NO. 37997  
SCALE 1:24  
DATE

**NOTE**  
DIMENSIONS SHOWN ARE APPROXIMATE AND ARE SUBJECT TO MINOR VARIATIONS AS MAY OCCUR OR BE NECESSARY IN CONSTRUCTION. MINOR DETAILS NOT SHOWN.

- BATTERY CHARGER LOCATED IN COMPARTMENT PER ORDER
- BATTERY CHARGER INDICATOR LOCATED ON DRIVER'S SEAT RISER
- L.E.D. LIGHT STRIPS LOCATED IN HOSE BED PER ORDER
- TWELVE ADJUSTABLE FULL WIDTH/FULL DEPTH SHELVES IN COMPARTMENTS PER ORDER
- FOUR FLOOR MOUNTED SLIDE-OUT TRAYS IN COMPARTMENTS PER ORDER
- SEVEN COMPARTMENT VENT WITH SPLASH GUARDS IN COMPARTMENTS PER ORDER
- TRIDENT FOLDING STEPS ON AERIAL DEVICE
- L.E.D. LIGHTING ON AERIAL LADDER SECTIONS
- 2-WAY INTERCOM SYSTEM BETWEEN AERIAL TIP OR PLATFORM AND TURNTABLE
- LIFTING EYE ROPE RESCUE ATTACHMENT AT AERIAL TIP

- AIR HORN CONTROLS AT AERIAL TURNTABLE
- 1500 GPM HIGH FLOW WATERWAY

REV	DATE	BY	CH	ENFORCER

TITLE	107' ASCENDANT AERIAL LADDER AND BODY ASSEMBLY
FOR	LONGWOOD FIRE DEPARTMENT LONGWOOD, FL
DWG NO.	37997AD

DRAWN BY	JGA	DATE	08SEP22
CHECKED BY	NDA	DATE	16SEP22
SHEET SIZE	D	SHEET NO.	1 OF 1