

- HOSEBED CAPACITIES
- ① - 400' OF 3.00" D.J.POLY HOSE
 - ② - 1000' OF 5.00" D.J.POLY HOSE
 - ③ - 400' OF 3.00" D.J.POLY HOSE
 - ④ - (2) HOSE BUNDLES EACH WITH
150' OF 1.75" D.J.POLY HOSE

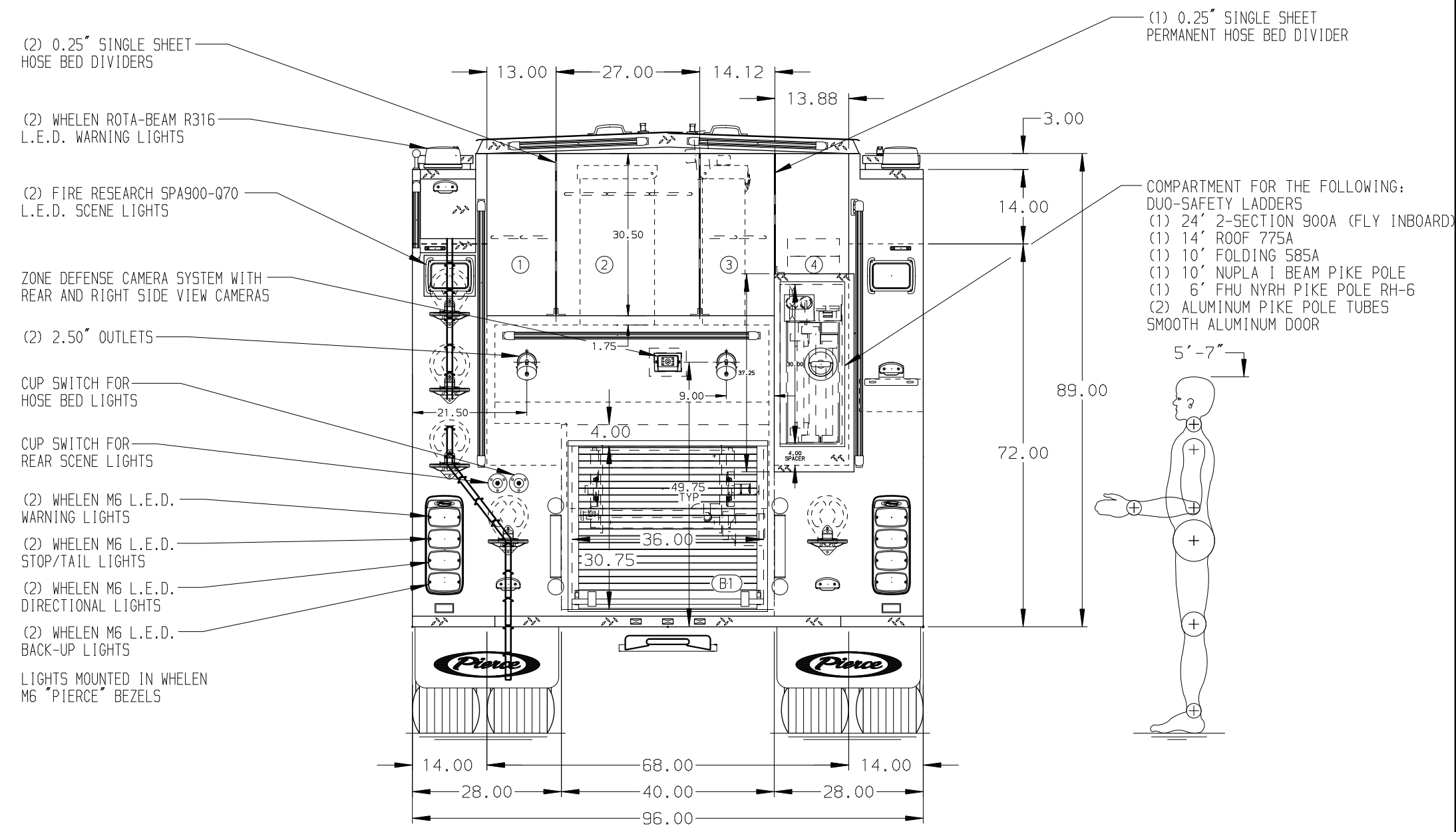

ALUMINUM

SIDE ROLL AND FRONTAL IMPACT PROTECTION

NOTE
DIMENSIONS SHOWN ARE APPROXIMATE
AND ARE SUBJECT TO MINOR DEVIATIONS
AS MAY OCCUR OR BE NECESSARY IN
CONSTRUCTION.
MINOR DETAILS NOT SHOWN.

- 1. DUAL L.E.D. LIGHT STRIPS LOCATED IN HOSE BED
- 2. DRIP PAN GUARD FOR ROLL-UP DOOR LOCATED PER SHOP ORDER
- 3. FIVE FULL WIDTH/DEPTH ADJUSTABLE SHELVES LOCATED PER SHOP ORDER
- 4. TWO FLOOR MOUNTED SLIDE-OUT TRAYS LOCATED PER SHOP ORDER
- 5. ONE ALUMINUM SWING-OUT TOOLBOARD LOCATED PER SHOP ORDER
- 6. ALUMINUM PEGBOARD INSTALLED ON BACK WALL OF COMPARTMENTS AND LOCATED PER SHOP ORDER
- 7. AIR INLET/OUTLET WITH DISCONNECT FITTING LOCATED PER SHOP ORDER
- 8. FOUR 120V DUPLEX RECEPTACLES LOCATED PER SHOP ORDER
- 9. HANNAY BOOSTER REEL MODEL EF4130-17-18 WITH 150' OF 0.75" BOOSTER HOSE AND 1/3 HP MOTOR IN COMPARTMENT B1
- 10. ONE FLOOR MOUNTED TWO-WAY SLIDE-OUT TRAY IN CREW CAB STORAGE COMPARTMENT
- 11. TWO SLIDE-OUT/TILT-DOWN ADJUSTABLE TRAYS IN CREW CAB STORAGE COMPARTMENT
- 12. ONE ADJUSTABLE 0.38" PLATE LOCATED PER SHOP ORDER
- 13. XANTREX FREEDOM HF1800 INVERTER LOCATED VERTICALLY PER SHOP ORDER

				CHASSIS DATA	TITLE
				MAKE	FOR
				MODEL	DWG NO.
REV	DATE	BY	CH	ENFORCER	

		JOB NO.	38104 01-02
		SCALE	DATE
		DRAWN BY	20APR23
		CHECKED BY	20APR23
		SHEET SIZE	SHEET NO.
		D	1 OF 1

1500-780P, 750G WATER, 30G FOAM, 161" FDLER PUMPER
LADDERS BTWN TANK & SS, (3) XLYS, DELUGE, HUSKY 3

KILLEEN FIRE DEPARTMENT
KILLEEN, TEXAS

38104AD