

**PUMPER  
BODY**

Long Aluminum 2nd Gen Pumper

**CHASSIS**

Impel Chassis

**CHASSIS  
AXLE, FRONT, CUSTOM**  
19,500 Lb TAK-4 Axle

**AXLE, REAR**  
24,000 Lb Meritor Axle

**ENGINE**  
450 HP Cummins L9 Engine

**TRANSMISSION**  
Allison 6th Gen, 3000 EVS P

**BUMPER**  
22" Extended Stainless Steel

**CAB**

7010 Impel FR Cab

**BODY  
WATER TANK**  
750 Gallon Poly Water Tank

**COMPT, PUMPER, REAR**  
44.50" FF RollUp Rear Compt

**COMPT, PUMPER, LEFT SIDE**  
161" RollUp Full Height Front & Rear FDLR

**COMPT, PUMPER, RIGHT SIDE**  
161" RollUp 3/4 Height, (1) Broom, FDLR

**FIRE SUPPRESSION  
PUMPHOUSE**

45" Control Zone Side Mount

**PUMP**

1500 GPM Waterous CSU

**CROSSLAYS, 1.50"**  
(2) 1.50" Standard Capacity

**CROSSLAYS, 2.50"**  
2.50" Crosslay Not Required

**SPEEDLAYS**

Speedlays Not Required

**GENERATOR**

Generator Not Required

**Foam System**  
Foam System Not Required

**Foam Cell**  
Foam Cell Not Required

Side Roll Protection

**NOTE**  
DIMENSIONS SHOWN ARE APPROXIMATE AND ARE SUBJECT TO MINOR DEVIATIONS AS MAY OCCUR OR BE NECESSARY IN CONSTRUCTION. MINOR DETAILS NOT SHOWN.

1. AUTOMATIC TIRE CHAINS
2. SHORELINE RECEPTACLE WITH KUSSMAUL SUPER AUTO-EJECT LOCATED ON DRIVER SIDE OF THE CAB
3. AIR INLET KUSSMAUL AIR EJECT IN THE DRIVER SIDE STEPWELL
4. BATTERY CHARGER LOCATED BEHIND DRIVER'S SEAT
5. BATTERY CHARGE INDICATOR LOCATED ON DRIVER SIDE OF CAB
6. NINE ADJUSTABLE SHELVES LOCATED PER ORDER
7. TWO FLOOR MOUNTED SLIDE-OUT TRAY LOCATED PER ORDER
8. PARTITIONS BETWEEN LS1/B1 & RS1/B1
9. LICENSE PLATE BRACKET SHIPPED LOOSE
10. MIC AND SPEAKER BOX LOCATED ON DRIVER SIDE PUMP PANEL PER SHOP ORDER

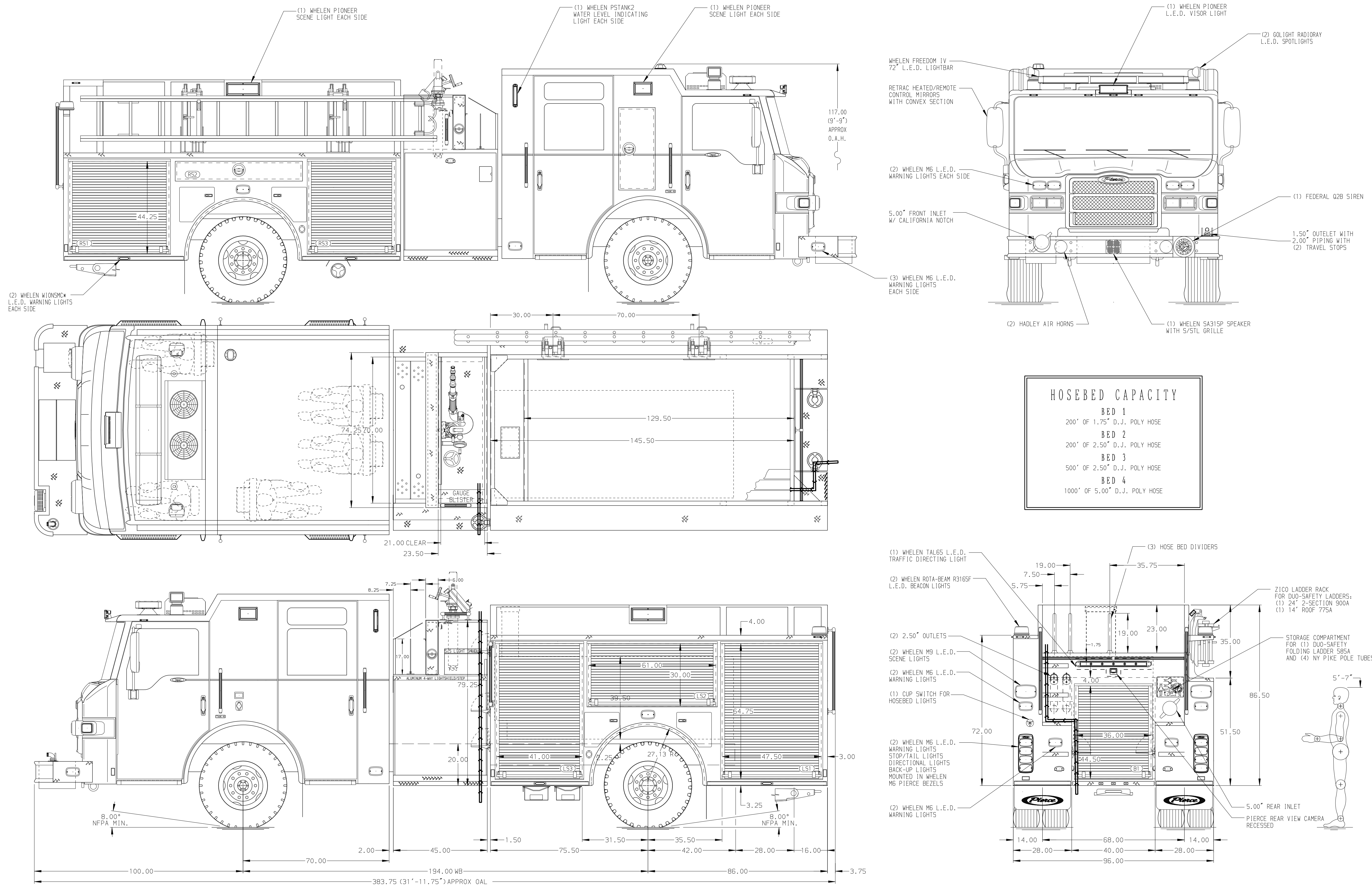

HOSEBED CAPACITY	
<b>BED 1</b>	200' OF 1.75" D.J. POLY HOSE
<b>BED 2</b>	200' OF 2.50" D.J. POLY HOSE
<b>BED 3</b>	500' OF 2.50" D.J. POLY HOSE
<b>BED 4</b>	1000' OF 5.00" D.J. POLY HOSE

		JOB NO.	38209
		SCALE	DATE
TITLE	Pierce Pumper Approval Drawing		
FOR	Bartonville Village Fire Department		
DWG NO.	38209AD		
REV	DATE	BY	CH
10APR23		MMF	CLM
09DEC22		MMF	CLM
15NOV22		COL	CLM
13OCT22		MMF	CLM
			IMPEL