

HOSEBED CAPACITIES
 ① 1000' OF 5.00" L.D. HOSE
 ② 600' OF 3.00" D.J. HOSE

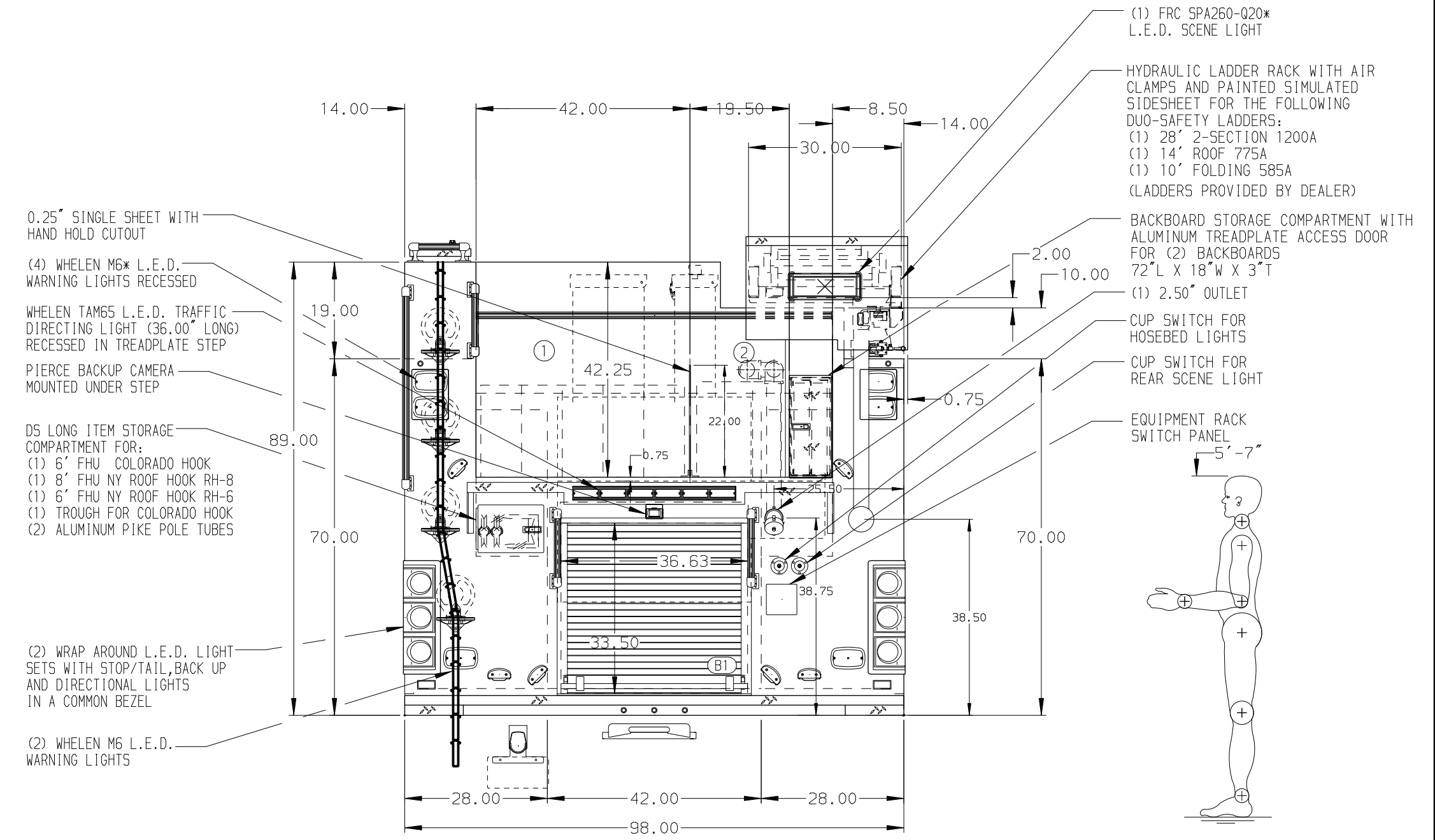

ALUMINUM BODY SIDE ROLL AND FRONTAL IMPACT PROTECTION

NOTE
 DIMENSIONS SHOWN ARE APPROXIMATE AND ARE SUBJECT TO MINOR DEVIATIONS AS MAY OCCUR OR BE NECESSARY IN CONSTRUCTION.
 MINOR DETAILS NOT SHOWN.

1. BATTERY CHARGER LOCATED PER ORDER
 2. BATTERY CHARGER INDICATOR LOCATED AT DRIVER'S SIDE STEP AREA
 3. DUAL L.E.D. LIGHT STRIPS LOCATED IN HOSE BED
 4. FIVE FULL WIDTH/DEPTH ADJUSTABLE SHELVES LOCATED PER ORDER
 5. THREE FLOOR MOUNTED SLIDE-OUT TRAYS LOCATED PER ORDER
 6. PARTITION BETWEEN COMPARTMENT LS1/RS1 AND RS1/RS1
 7. 4-WAY ALUMINUM ON THE FLOOR LOCATED PER ORDER
 8. AIR INLET WITH DISCONNECT COUPLING LOCATED IN DS STEP WELL
 9. THREE 120V NEMA DUPLEX RECEPTACLES LOCATED PER ORDER

10. INVERTER/ BATTERY CHARGER LOCATED PER ORDER
 11. AIR COMPRESSOR LOCATED BEHIND DRIVER'S SEAT
 12. ONE ADJUSTABLE SLIDE-OUT TRAY LOCATED PER ORDER

REV	DATE	BY	CH	VELOCITY FR
26JAN24	KLE	GKH		CHASSIS DATA
04JAN24	KLE	GKH		MAKE
06SEP23	LME	ZWE		PIERCE
29AUG23	LME	ZWE		MODEL
10JUL23	LME	ZWE		

		JOB NO.	38430		
		SCALE	DATE		
TITLE	1500-D-520P, 500 WATER W/20 FOAM, 189" PUMPER PUC (4) CROSSLAYS, HUSKY 3, HYDRAULIC LADDER RACK		DRAWN BY	LME	08MAY23
FOR	ADAMS COUNTY FIRE RESCUE DENVER, COLORADO		CHECKED BY	EGO	10MAY23
DWG NO.	38430AD		SHEET SIZE	D	SHEET NO.
					1 OF 1