

HOSEBED CAPACITIES

① - 1200' OF 3.00" D.J. POLY HOSE

② - 500' OF 2.50" D.J. POLY HOSE

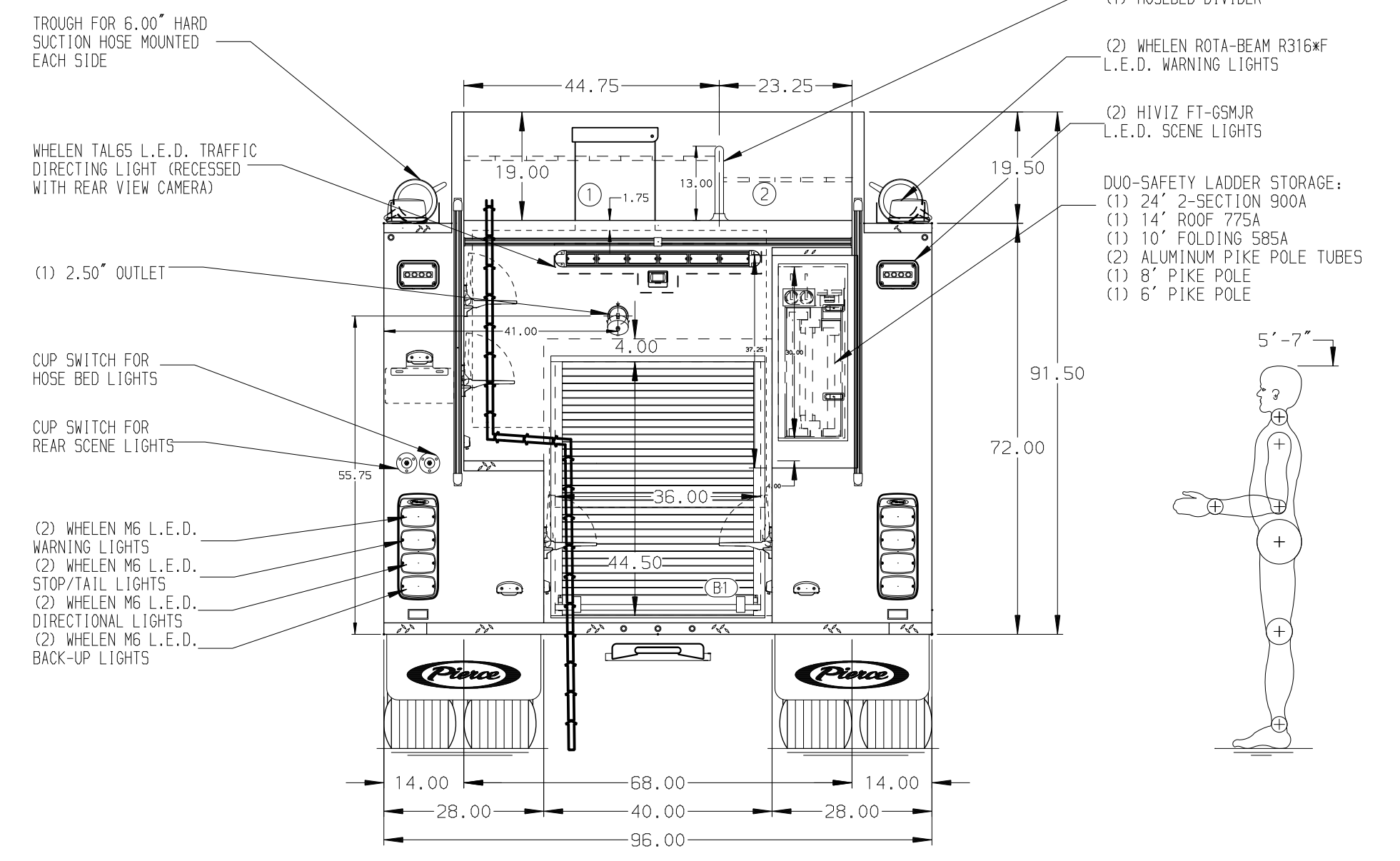
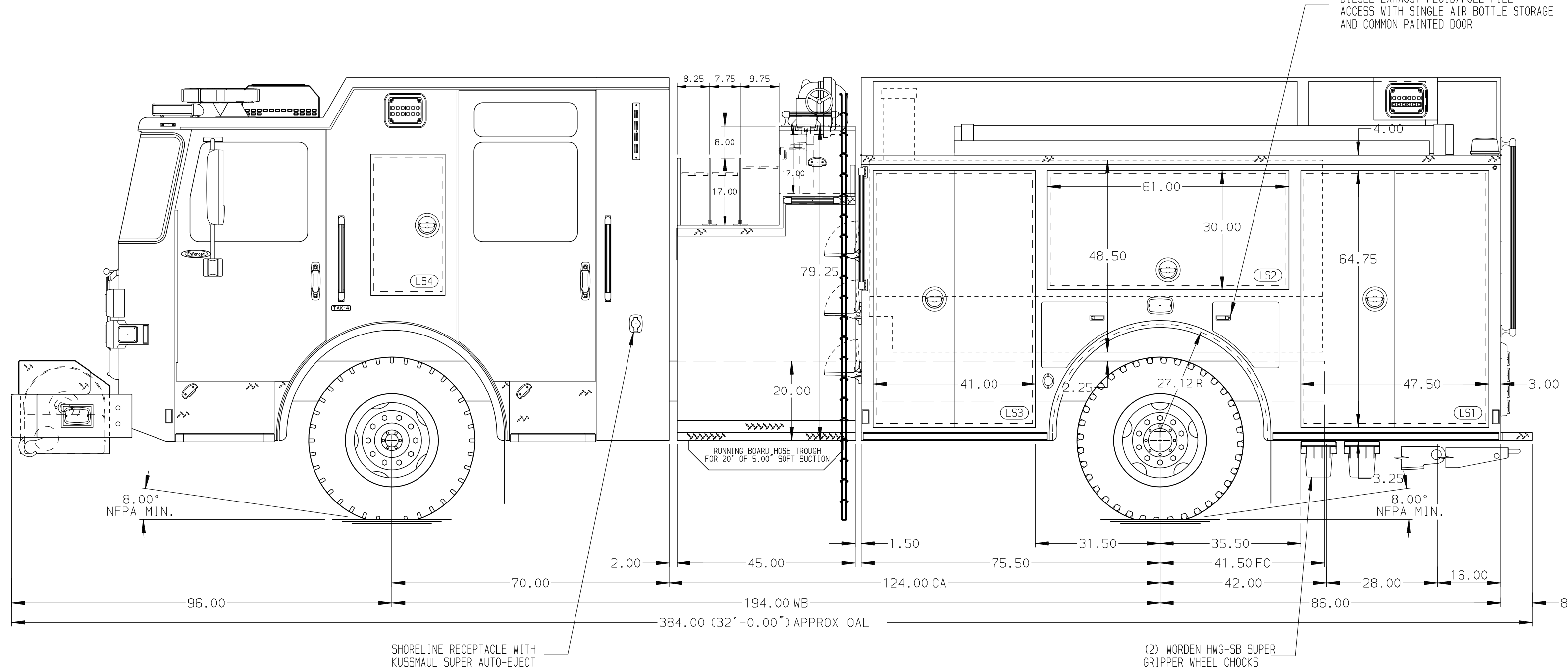

ALUMINUM BODY

NOTE
DIMENSIONS SHOWN ARE APPROXIMATE AND ARE SUBJECT TO MINOR DEVIATIONS AS MAY OCCUR OR BE NECESSARY IN CONSTRUCTION. MINOR DETAILS NOT SHOWN.

- BATTERY CHARGER/AIR COMPRESSOR LOCATED PER SHOP ORDER
- BATTERY CHARGER INDICATOR LOCATED ON DRIVER'S SEAT RISER
- DUAL L.E.D. LIGHT STRIPS LOCATED IN HOSE BED
- DRIP PAN GUARD FOR ROLL-UP DOOR LOCATED PER SHOP ORDER
- PULL STRAP ON DOOR IN COMPARTMENT LOCATED PER SHOP ORDER
- FIVE FULL WIDTH/DEPTH ADJUSTABLE SHELVES LOCATED PER SHOP ORDER
- THREE FLOOR MOUNTED SLIDE-OUT TRANS LOCATED PER SHOP ORDER
- ONE SWING-OUT ALUMINUM TOOL BOARD LOCATED PER SHOP ORDER
- AIR INLET/OUTLET WITH DISCONNECT FITTING LOCATED PER SHOP ORDER
- TWO 4-WAY ALUMINUM COMPARTMENT FLOORS LOCATED PER SHOP ORDER

REV	DATE	BY	CH	ENFORCER
15NOV23	JJB	CHR		MAKE
12OCT23	JJB	CHR		PIERCE
04AUG23	JJB	WKL		MODEL

		JOB NO.	38543
		SCALE	DATE
TITLE	1500-D-1000P, 1000 GALLON WATER TANK, 161" BODY LADDERS BTWN TANK & SS, (3) CROSSLAYS, DELUGE	DRAWN BY	JJB
FOR	ST. TAMMANY FIRE PROTECTION DISTRICT #11 PEARL RIVER, LOUISIANA	CHECKED BY	WKL
DWG NO.	38543AD	SHEET SIZE	SHEET NO.
		D	1 OF 1