

PUMPER BODY

Long Aluminum 2nd Gen Pumper

CHASSIS

Sober FR Chassis

CHASSIS AXLE, FRONT, CUSTOM

18,000 Lb Dana Axle

AXLE, REAR

27,000 Lb Dana Axle

ENGINE

450 HP Cummins L9 Engine

TRANSMISSION

Allison 5th Gen, 3000 EVS P

BUMPER

19" Extended Pointed Steel

CAB

6010 Sober FR Cab

BODY

WATER TANK

1000 Gallon Water Tank

COMPT, PUMPER, REAR

44.50" FF RollUp Rear Compt

COMPT, PUMPER, LEFT SIDE

161" RollUp Full Height Front & Rear FDLR

COMPT, PUMPER, RIGHT SIDE

161" RollUp Full Height Front & Rear FDLR

FIRE SUPPRESSION PUMPHOUSE

45" Control Zone Side Mount

PUMP

1500 GPM Waterous CSU

CROSSLAYS, 1.50"

(3) 1.50" Standard Capacity

CROSSLAYS, 2.50"

2.50" Crosslay Not Required

SPEEDLAYS

Speedlays Not Required

GENERATOR

Generator Not Required

Foam System

Husky 3 Single Agent Foam System

Foam Cell

20 Gallon Foam Cell, Not Reduced Water

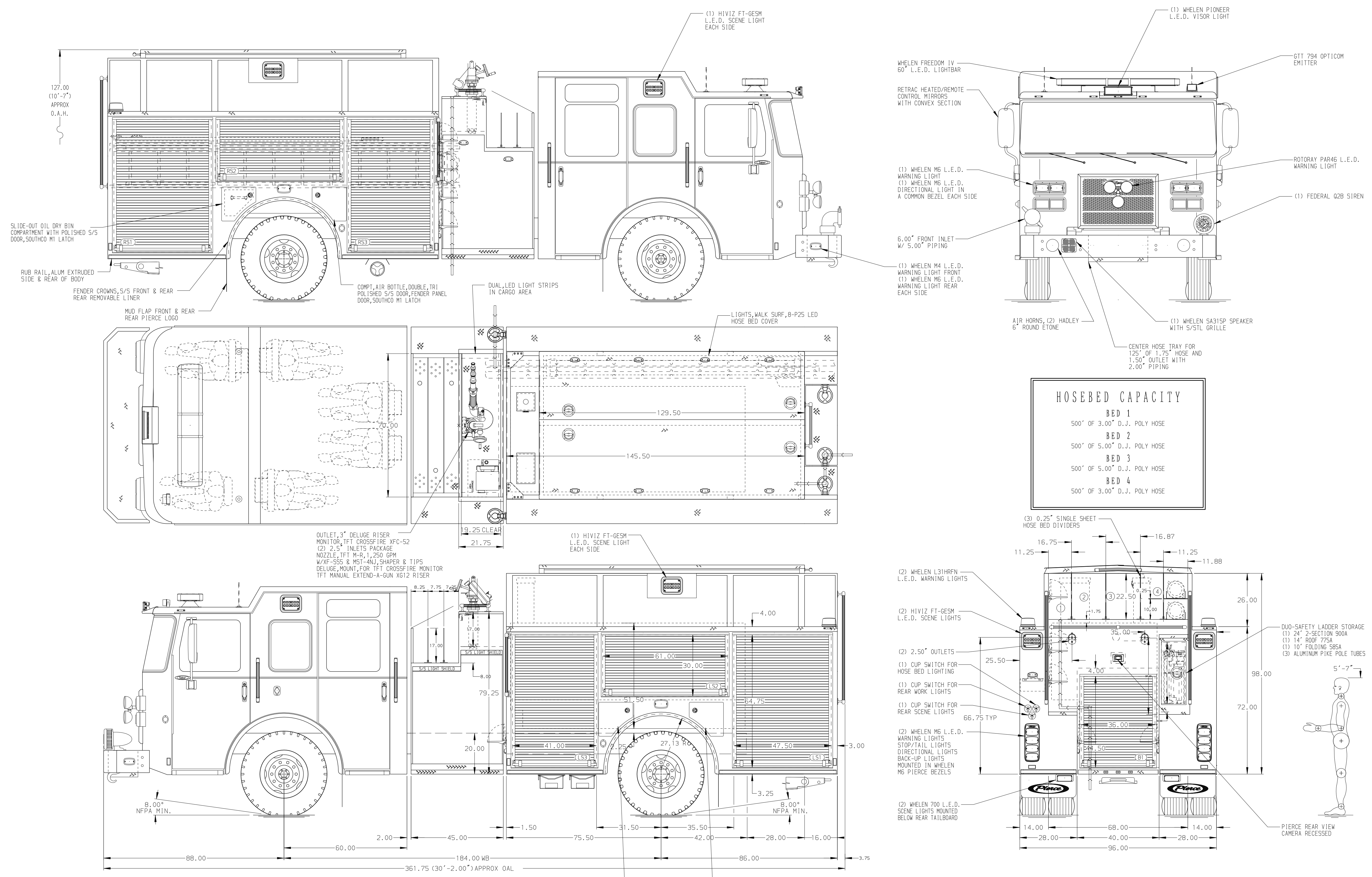

HOSEBED CAPACITY	
BED 1	500' OF 3.00" D.J. POLY HOSE
BED 2	500' OF 5.00" D.J. POLY HOSE
BED 3	500' OF 5.00" D.J. POLY HOSE
BED 4	500' OF 3.00" D.J. POLY HOSE

NOTE
DIMENSIONS SHOWN ARE APPROXIMATE AND ARE SUBJECT TO MINOR DEVIATIONS AS MAY OCCUR OR BE NECESSARY IN CONSTRUCTION. MINOR DETAILS NOT SHOWN.

				JOB NO.	38706
				SCALE	1:24
TITLE Pierce Pumper Approval Drawing MAKE - FOR Weston Fire Department				DATE	
				DRAWN BY	MMF
DWG NO. 38706AD				CHECKED BY	COL
				DATE	20JUN22
REV	DATE	BY	CH	SHEET SIZE	D
06JAN23		JJB	CCS	SHEET NO.	1 OF 1
07NOV22		JLA	CCS		