

**PUMPER BODY**

Medium Aluminum 2nd Gen Pumper

**CHASSIS**

Sober FR Chassis

**CHASSIS AXLE, FRONT, CUSTOM**

18,000 Lb Dana Axle

**AXLE, REAR**

24,000 Lb Dana Axle

**ENGINE**

450 HP Cummins L9 Engine

**TRANSMISSION**

Allison 5th Gen, 3000 EVS P

**BUMPER**

19" Extended Painted Steel

**CAB**

7010 Sober FR Cab

**BODY WATER TANK**

750 Gallon New York Style Water Tank

**COMPT, PUMPER, REAR**

37.75" FF Rollup Rear Compt

**COMPT, PUMPER, LEFT SIDE**

152" Lap Full Height Front & Rear FOLER

**COMPT, PUMPER, RIGHT SIDE**

152" Lap Full Height Front & Rear FOLER

**FIRE SUPPRESSION PUMPHOUSE**

45" Control Zone Side Mount

**PUMP**

1500 GPM Waterous CSU

**CROSSLAYS, 1.50"**

1.50" Crosslays Not Required

**CROSSLAYS, 2.50"**

2.50" Crosslay Not Required

**SPEEDLAYS**

(2) 1.50" W/Tray Std. Capacity

**GENERATOR**

Generator Not Required

**Foam System**

Foam System Not Required

**Foam Cell**

Foam Cell Not Required

Side Roll and Frontal Impact Protection

**NOTE**

DIMENSIONS SHOWN ARE APPROXIMATE AND ARE SUBJECT TO MINOR DEVIATIONS AS MAY OCCUR OR BE NECESSARY IN CONSTRUCTION. MINOR DETAILS NOT SHOWN.

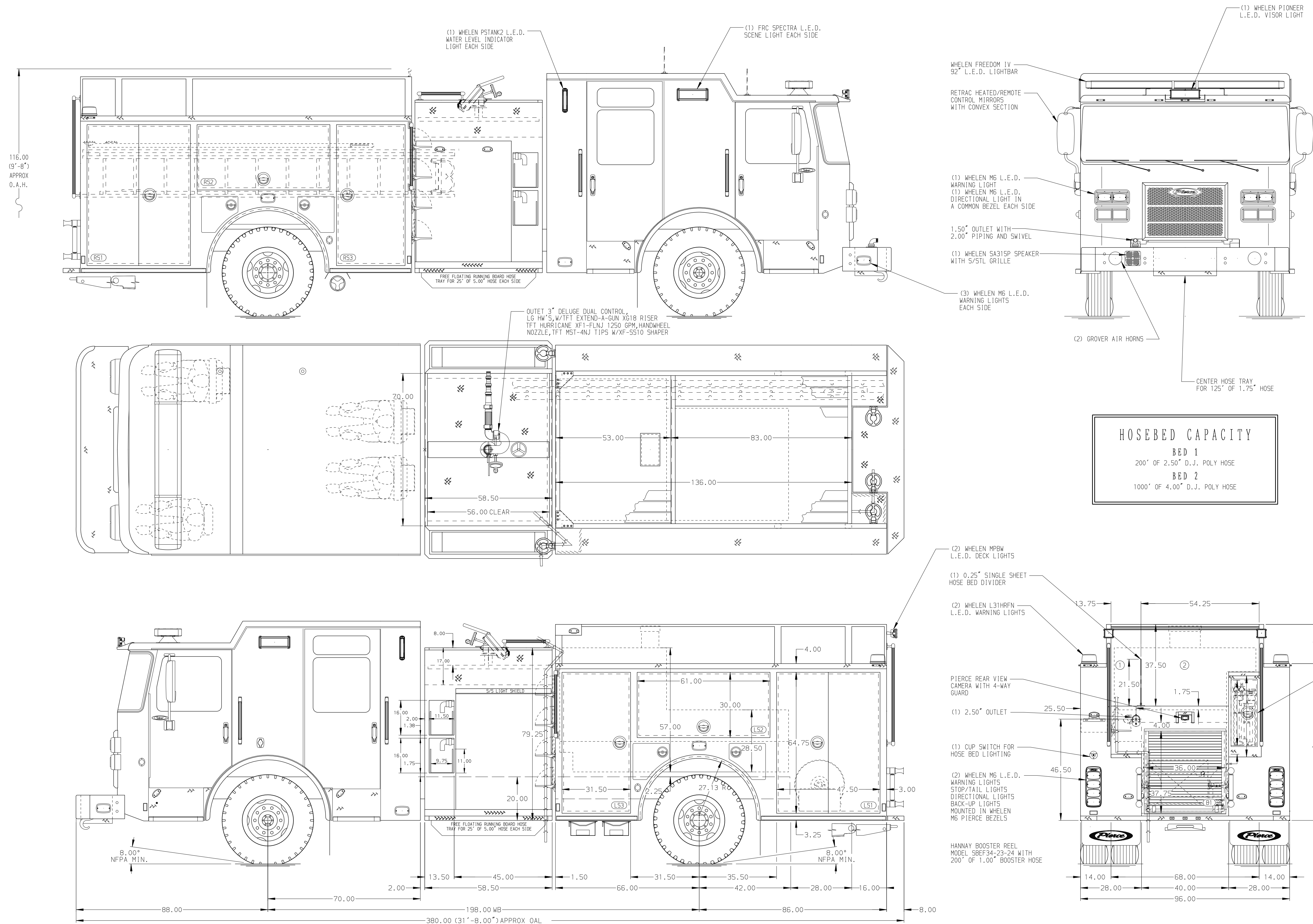

CUSTOMER APPROVAL				Pierce MANUFACTURING INC.	JOB NO.	38779	
APPROVED BY:					SCALE	1:24	DATE
DATE:				TITLE	Pierce Pumper Approval Drawing		
CHASSIS DATA	MAKE	PIERCE	MODEL	FOR	Benton Fire Department		
REV	DATE	BY	CH	DWG NO.	38779AD		
					CHECKED BY	COL	250CT22
					SHEET SIZE	D	SHEET NO. 1 OF 1