

SURFACE DESIGNATION AND PATHWAY MARKINGS

| BODY | WATER TANK |
|-----------------------------|--|
| 107' ASL Aluminum Body | 500 Gallon Poly Water Tank |
| COMPT, LEFT SIDE FRONT | Foam System |
| Full Height RollUp Forward | Husky 3 Single Agent Foam System |
| COMPT, LEFT SIDE REAR | Foam Cell |
| Full Height RollUp Rearward | 25 Gallon Foam Cell, Non Reduced Water |
| COMPT, RIGHT SIDE FRONT | |
| Full Height RollUp Forward | |
| COMPT, RIGHT SIDE REAR | |
| Full Height RollUp Rearward | |

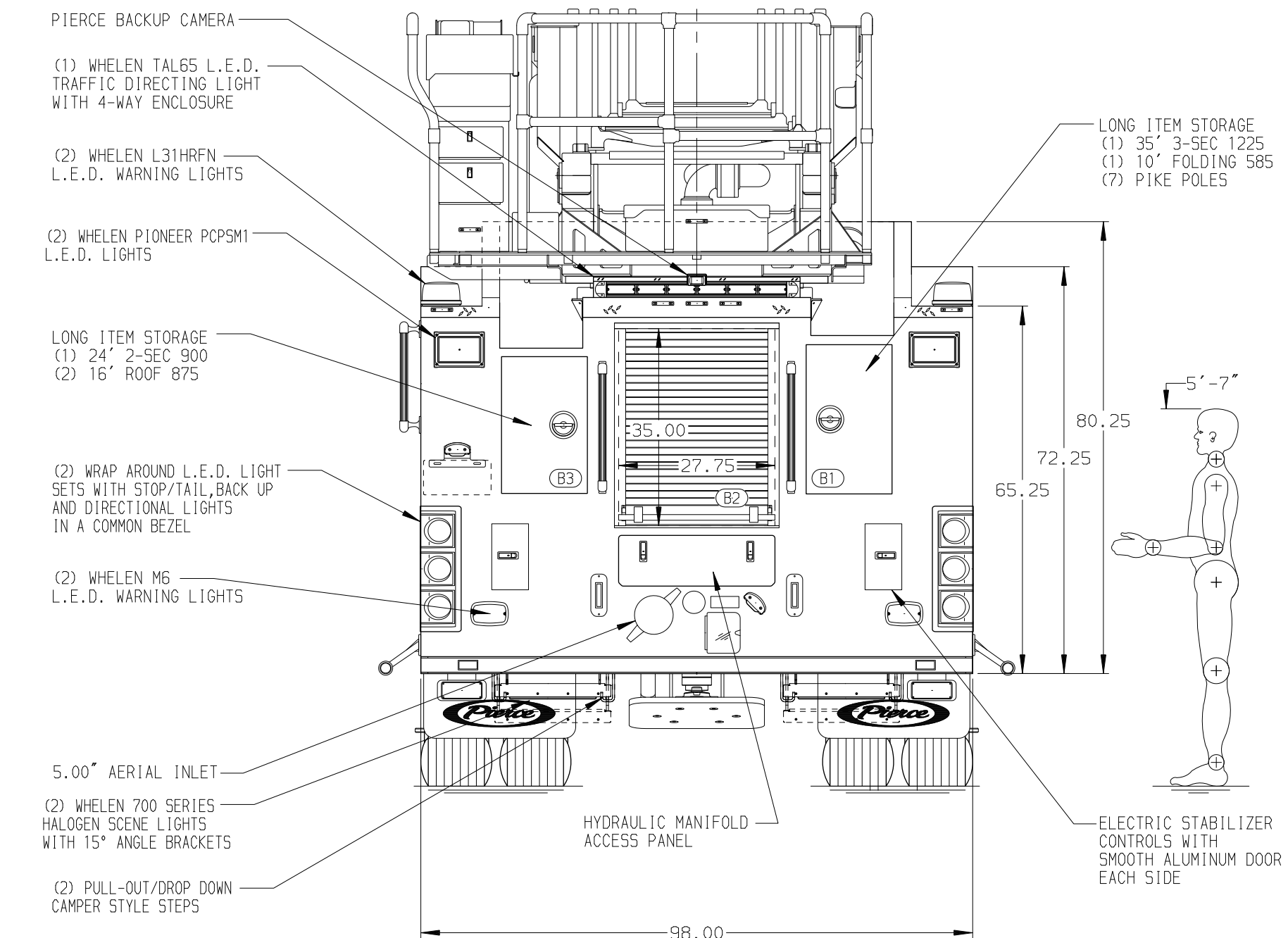
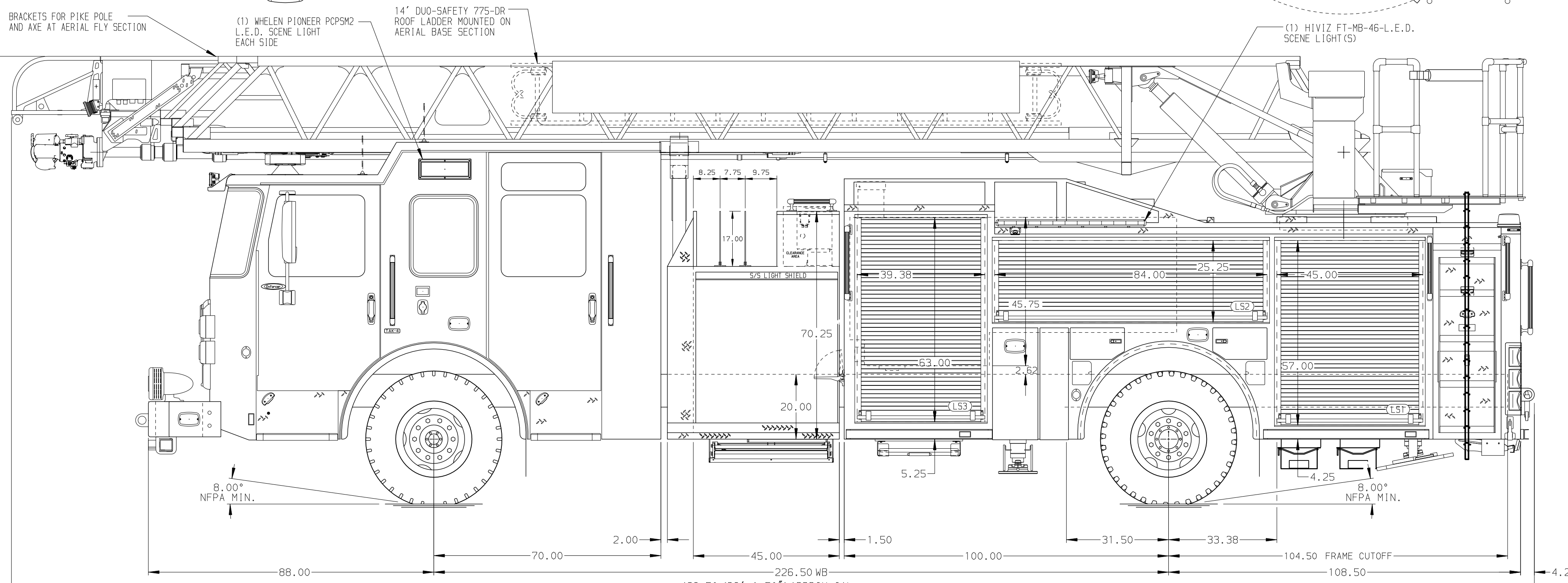

| CHASSIS | CAB | AXLE, FRONT, CUSTOM | TRANSMISSION | PUMPHOUSE | CROSSLAYS, 1.50" | SPEEDLAYS |
|---------------------------|----------------------------|------------------------|-----------------------------|-----------------------------|-----------------------------|------------------------|
| Enforcer Chassis | 7010 Notched Enforcer Cab | 22,800 Lb TAK-4 Axle | Allison 6th Gen, 4500 EV5 P | 45" Control Zone Side Mount | (2) 1.50" Standard Capacity | Speedlays Not Required |
| ENGINE | BUMPER | AXLE, REAR | | PUMP | CROSSLAYS, 2.50" | GENERATOR |
| 500 HP Cummins X12 Engine | 19" Extended Painted Steel | 33,500 Lb Meritor Axle | | 2000 GPM Waterous CSU | (1) 2.50" Standard Capacity | Generator Not Required |

NOTE
DIMENSIONS SHOWN ARE APPROXIMATE AND ARE SUBJECT TO MINOR DEVIATIONS AS MAY OCCUR OR BE NECESSARY IN CONSTRUCTION. MINOR DETAILS NOT SHOWN.

- NO LIMITED RETRACTION REQUIRED
- WARN WINCH ZEON 10-5 KIT PER ORDER
- SHOULDER RECEPTACLE WITH KISSMALL SUPER AUTO-EJECT LOCATED ON DRIVER SIDE OF THE CAB
- AIR INLET WITH DISCONNECT COUPLING IN THE DRIVER SIDE STEPWELL
- BATTERY CHARGER LOCATED PER ORDER
- TEN ADJUSTABLE SHELVES LOCATED PER ORDER
- FOUR FLOOR MOUNTED SLIDE-OUT TRAY LOCATED PER ORDER
- NON-RAISED AERIAL PEDESTAL
- LIFTING EYE ROPE RESCUE ATTACHMENT AT AERIAL TIP
- 1500 GPM HIGH FLOW WATERWAY
11. 51X 120V RECEPTACLES PER ORDER
- RUNG LIGHTING ON AERIAL LADDER
- TWO SWING-OUT TOOLBOARDS PER ORDER

| REV | DATE | BY | CH | ENFORCER |
|---------|------|-----|----|----------|
| 19MAR24 | LWE | KZW | | MAKE |
| 05JAN24 | LWE | AST | | PIERCE |
| 13OCT23 | LWE | AST | | MODEL |

PIERCE MANUFACTURING INC.

| | |
|------------|---------|
| JOB NO. | 38832 |
| SCALE | 1:24 |
| DATE | 21AUG23 |
| DRAWN BY | LWE |
| CHECKED BY | NDA |
| DATE | 23AUG23 |
| SHEET SIZE | D |
| SHEET NO. | 1 OF 1 |

TITLE 107' ASCENDANT AERIAL LADDER AND BODY ASSEMBLY
FOR GULF SHORES FIRE RESCUE
 GULF SHORES, AL
DWG NO. 38832AD