

<b>BODY</b> 107' ASL Aluminum Body	<b>WATER TANK</b> 500 Gallon Poly Water Tank
<b>COMPT, LEFT SIDE FRONT</b> Full Height RollUp Forward	<b>Foam System</b> Foam System Not Required
<b>COMPT, LEFT SIDE REAR</b> Full Height RollUp Rearward	<b>Foam Cell</b> Foam Cell Not Required
<b>COMPT, RIGHT SIDE FRONT</b> Full Height RollUp Forward	
<b>COMPT, RIGHT SIDE REAR</b> Full Height RollUp Rearward	

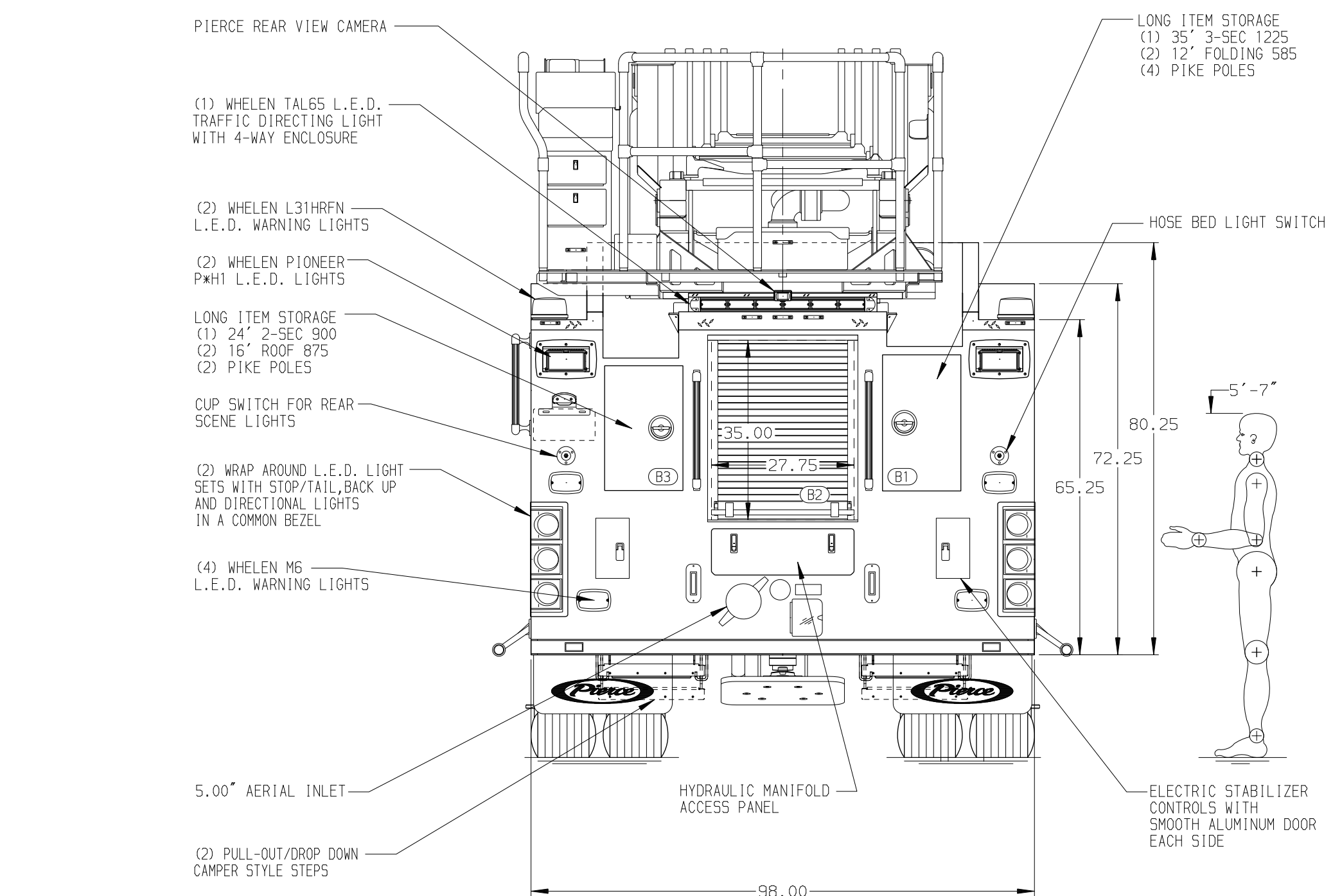
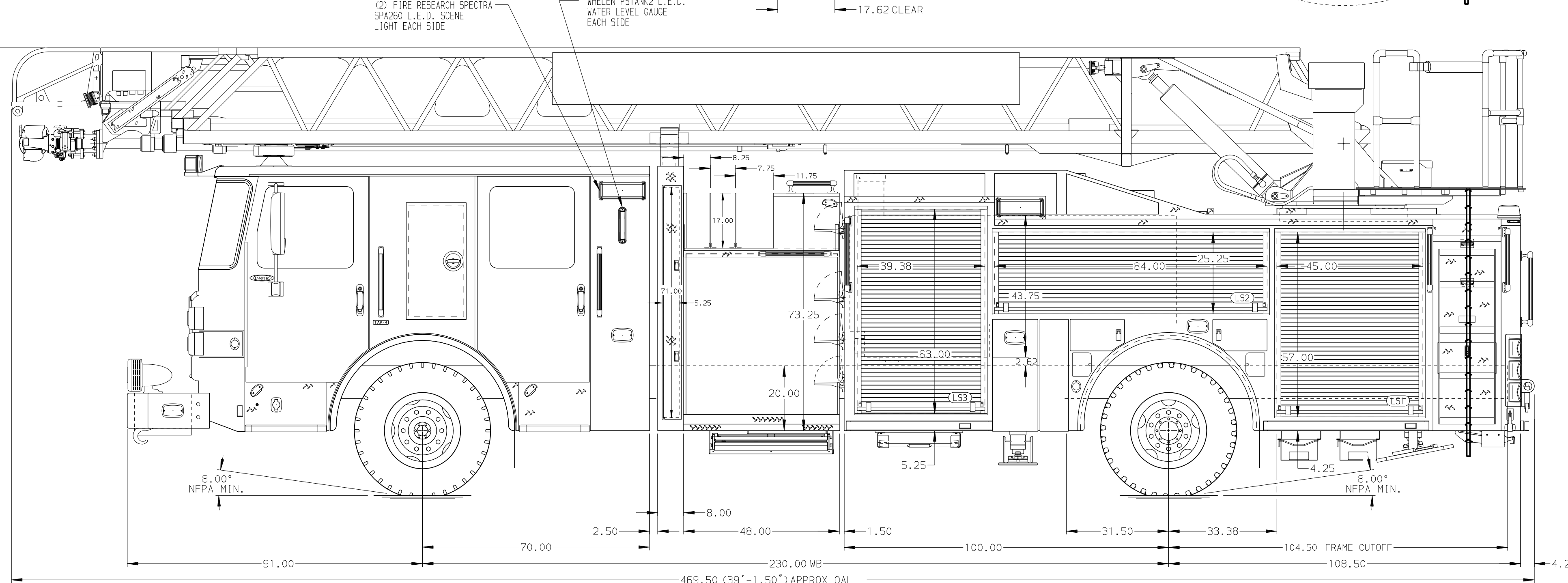

<b>CHASSIS</b> Enforcer Chassis 450 HP Cummins L9 Engine	<b>CAB</b> 7000 Enforcer Cab 22\"/>
--	---

<b>TRANSMISSION</b> Allison 6th Gen, 3000 EV5 P	<b>PUMPHOUSE</b> 48\"/>
--	----------------------------

<b>CROSSLAYS, 1.50\"/&gt; </b>
--------------------------------

**NOTE**  
DIMENSIONS SHOWN ARE APPROXIMATE AND ARE SUBJECT TO MINOR DEVIATIONS AS MAY OCCUR OR BE NECESSARY IN CONSTRUCTION. MINOR DETAILS NOT SHOWN.

- NO LIMITED RETRACTION REQUIRED
- ONE 1.50\"/>
- SHOULDER RECEPTACLE WITH KUSSMALL SUPER AUTO-EJECT LOCATED IN DRIVERS STEPWELL
- AIR INLET WITH DISCONNECT COUPLING IN THE DRIVER SIDE STEPWELL
- BATTERY CHARGER LOCATED PER ORDER
- FIVE ADJUSTABLE SHELVES LOCATED PER ORDER
- TWO FLOOR MOUNTED SLIDE-OUT TRAYS LOCATED PER ORDER
- NON-RAISED AERIAL PEDESTAL
- LIFTING EYE ROPE RESCUE ATTACHMENT AT AERIAL TIP
- 1500 GPM HIGH FLOW WATERWAY
- RUNG LIGHTING ON AERIAL LADDER
- WIRELESS CAMERA ON EGRESS PER ORDER
- ONE SWING-OUT TOOLBOARD PER ORDER

<b>SAFETY</b> Side Roll and Frontal Impact Protection	<b>SPEEDLAYS</b> Speedlays Not Required Generator
--	---

**Pierce MANUFACTURING INC.**

JOB NO. 38986

SCALE 1:24 DATE

DRAWN BY LWE DATE 06SEP23

CHECKED BY NAK DATE 08SEP23

SHEET SIZE D SHEET NO. 1 OF 1

TITLE 107' ASCENDANT AERIAL LADDER AND BODY ASSEMBLY

FOR RAINBOW CITY, RAINBOW CITY, AL

DWG NO. 38986AD

REV	DATE	BY	CH	ENFORCER
06FEB24	LWE	CSH		
08NOV23	LWE	CSH		