

PUMPER BODY

Long Aluminum 2nd Gen Pumper

CHASSIS

Enforcer Chassis

CHASSIS AXLE, FRONT, CUSTOM

19,500 Lb TAK-4 Axle

AXLE, REAR

27,000 Lb Dana Axle

ENGINE

510 HP Paccor MX13 Engine

TRANSMISSION

Allison 6th Gen, 4500 EVS P

BUMPER

26" Extended Pointed Steel

CAB

7010 Enforcer Cab

BODY WATER TANK

750 Gallon New York Style Water Tank

COMPT, PUMPER, REAR

30.75" FF RollUp Rear Compt

COMPT, PUMPER, LEFT SIDE

161" RollUp Full Height Front & Rear FDLR

COMPT, PUMPER, RIGHT SIDE

161" RollUp Full Height Front & Rear FDLR

FIRE SUPPRESSION PUMPHOUSE

45" Control Zone Side Mount

PUMP

1500 GPM Hale QMAX

CROSSLAYS, 1.50"

1.50" Crosslays Not Required

CROSSLAYS, 2.50"

2.50" Crosslay Not Required

SPEEDLAYS

Speedlays Not Required

GENERATOR

Generator Not Required

Foam System

Husky 3 Single Agent Foam System

Foam Cell

20 Gallon Foam Cell, Reduced Water

NOTE
DIMENSIONS SHOWN ARE APPROXIMATE AND ARE SUBJECT TO MINOR DEVIATIONS AS MAY OCCUR OR BE NECESSARY IN CONSTRUCTION. MINOR DETAILS NOT SHOWN.

- ONE 1.50 OUTLET WITH 2.00 PIPING AND SWIVEL LOCATED IN RIGHT SIDE BUMPER TRAY
- SHOULDER RECEPTACLE WITH KISSMALL SUPER AUTO-EJECT LOCATED ON DRIVER SIDE OF CAB
- BATTERY CHARGER LOCATED PER ORDER
- EIGHT ADJUSTABLE SHELVES LOCATED PER ORDER
- THREE FLOOR MOUNTED SLIDE-OUT TRAYS LOCATED PER ORDER
- ONE SWING-OUT TOOLBOARD LOCATED PER SHOP ORDER
- PEGGBOARDS ON BACK WALL LOCATED PER SHOP ORDER
- AIR INLET WITH DISCONNECT COUPLING LOCATED IN DRIVER SIDE STEPWELL FORWARD
- HOSE STORAGE RACK LOCATED PER SHOP ORDER

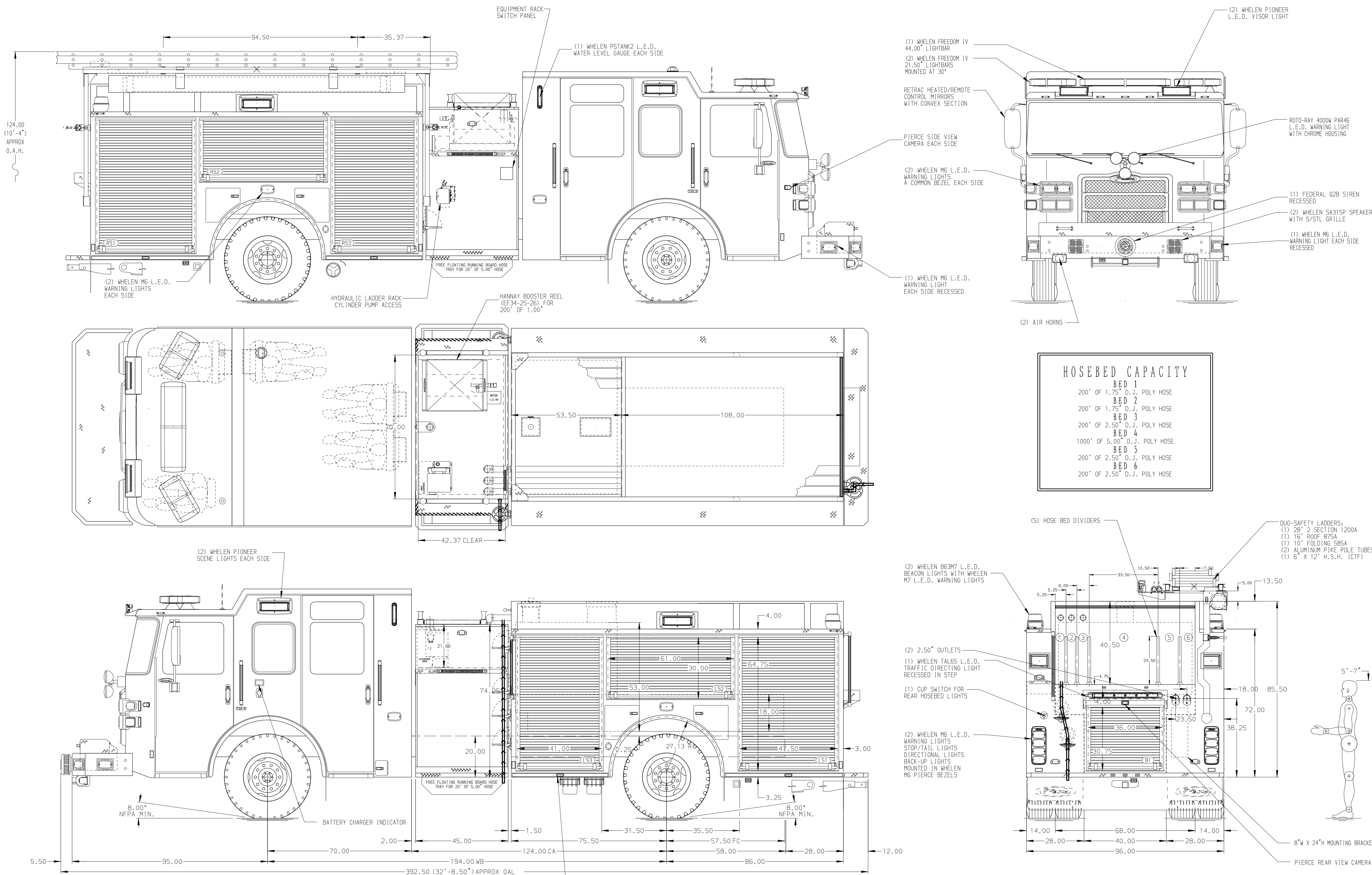

HOSEBED CAPACITY	
BED 1	200' OF 1.75" D.J. POLY HOSE
BED 2	200' OF 1.75" D.J. POLY HOSE
BED 3	200' OF 2.50" D.J. POLY HOSE
BED 4	1000' OF 5.00" D.J. POLY HOSE
BED 5	200' OF 2.50" D.J. POLY HOSE
BED 6	200' OF 2.50" D.J. POLY HOSE

		JOB NO.	39077
		SCALE	DATE
TITLE	Pierce Pumper Approval Drawing	DRAWN BY	WRE
FOR	Chester County Fire Service	CHECKED BY	MMF
DWG NO.	39077AD	SHEET SIZE	SHEET NO.
		D	1 OF 1

REV	DATE	BY	CH	ENFORCER
26JAN24	MMF	JGO		PIERCE
10NOV23	MMF	JGO		MODEL