

PUMPER BODY

Long Aluminum 2nd Gen Pumper

CHASSIS

Saber Chassis

CHASSIS AXLE, FRONT, CUSTOM

19,500 Lb TAK-4 Axle

AXLE, REAR

27,000 Lb Dana Axle

ENGINE

450 HP Cummins L9 Engine

TRANSMISSION

Allison 6th Gen, 3000 EVS P

BUMPER

19" Underslung Painted Steel

CAB

6010 Enforcer Cab

BODY

WATER TANK

1000 Gallon Poly Water Tank

COMPT, PUMPER, REAR

44.50" FF RollUp Flush Rear Compt

COMPT, PUMPER, LEFT SIDE

161" RollUp Full Height Front & Rear FDLER

COMPT, PUMPER, RIGHT SIDE

161" RollUp Full Height Front & Rear FDLER

FIRE SUPPRESSION PUMPHOUSE

45" Control Zone Side Mount

PUMP

1500 GPM Waterous CSU

CROSSLAYS, 1.50"

1.50" Crosslay Not Required

CROSSLAYS, 2.50"

(1) 2.50" Special Capacity
(1) 2.00" Special Capacity

SPEEDLAYS

(2) 1.50" W/Tray Std. Capacity

GENERATOR

Generator Not Required

Foam System

Foam System Not Required

Foam Cell

Foam Cell Not Required

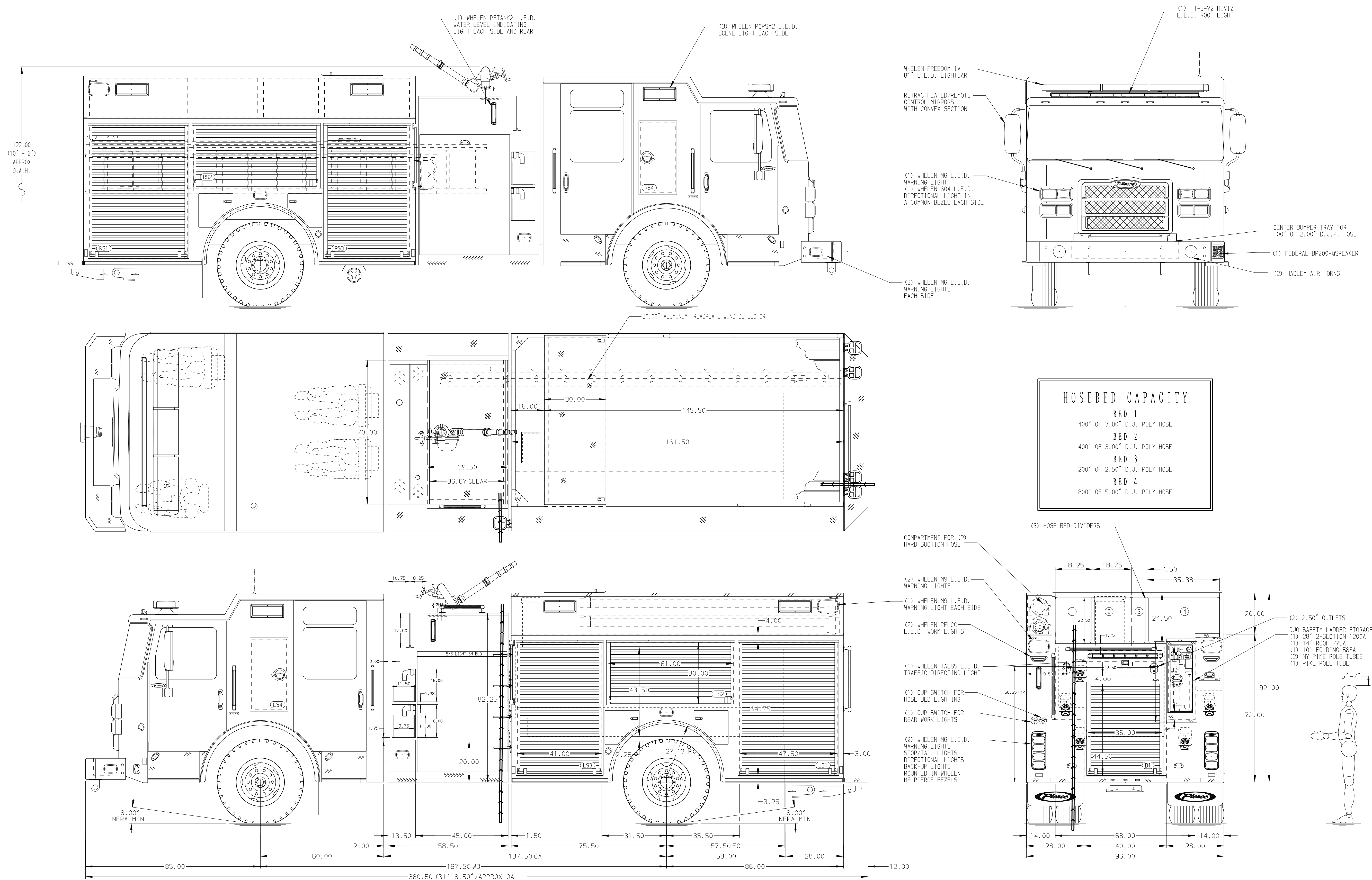

HOSEBED CAPACITY	
BED 1	400' OF 3.00" D.J. POLY HOSE
BED 2	400' OF 3.00" D.J. POLY HOSE
BED 3	200' OF 2.50" D.J. POLY HOSE
BED 4	800' OF 5.00" D.J. POLY HOSE

NOTE
DIMENSIONS SHOWN ARE APPROXIMATE AND ARE SUBJECT TO MINOR DEVIATIONS AS MAY OCCUR OR BE NECESSARY IN CONSTRUCTION. MINOR DETAILS NOT SHOWN.

1. AUTOMATIC TIRE CHAINS
2. SHORELINE RECEPTACLE WITH KUSSMAUL SUPER AUTO-EJECT LOCATED ON DRIVER SIDE OF THE CAB
3. BATTERY CHARGER LOCATED PER ORDER
4. SEVEN ADJUSTABLE SHELVES LOCATED PER ORDER
5. ONE FLOOR MOUNTED SLIDE-OUT TRAY LOCATED PER ORDER
6. RESPOND READY FOUR DRAWER STORAGE COMPARTMENT LOCATED PER ORDER
7. ONE VERTICAL PARTITION LOCATED PER ORDER
8. ONE 2.50 OUTLET WITH 2.50 PIPING AND SHIVEL LOCATED PER ORDER
9. KUSSMAUL AIR COMPRESSOR LOCATED PER SHOP ORDER
10. WHEEL CHOCKS AND MOUNTING SUPPLIED BY FIRE DEPARTMENT

11. ONE CTECH THREE DRAWER ASSEMBLY LOCATED PER ORDER
12. THREE PEGBOARDS MOUNTED ON THE BACK WALLS OF COMPARTMENTS LOCATED PER ORDER

REV	DATE	BY	CH	ENFORCER
16APR24	JJB	DTJ		CHASSIS DATA
12MAR24	JJB	DTJ		MAKE
19DEC23	JJB	JKR		PIERCE
06DEC23	JJB	JKR		MODEL

		JOB NO.	39577
		SCALE	DATE
TITLE	Pierce Pumper Approval Drawing	DRAWN BY	JJB
FOR	Bettendorf IA	CHECKED BY	MMF
DWG NO.	39577AD	SHEET SIZE	SHEET NO.
		D	1 OF 1